

RoHS

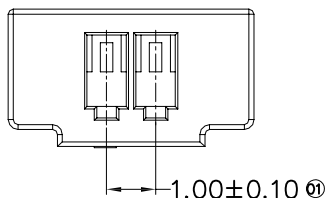

■ Specifications

- Voltage rating: 50V AC / DC
- Current rating: 1A AC / DC
- Withstanding voltage: 500V AC/minute
- Temperature range: -25° ~ +85°
- Insulation resistance: ≥100MΩ
- Contact resistance: ≤20mΩ
- After environmental testing : ≤40mΩ
- Suitable GYA Terminal: A1002T
- Mates With GYA Wafer: A1002W

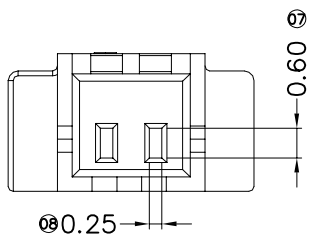
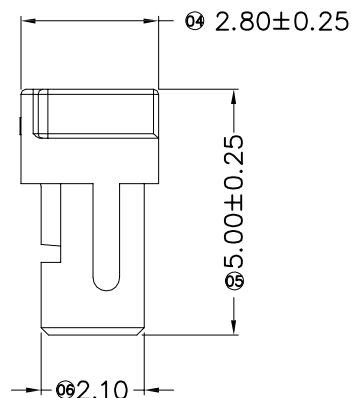
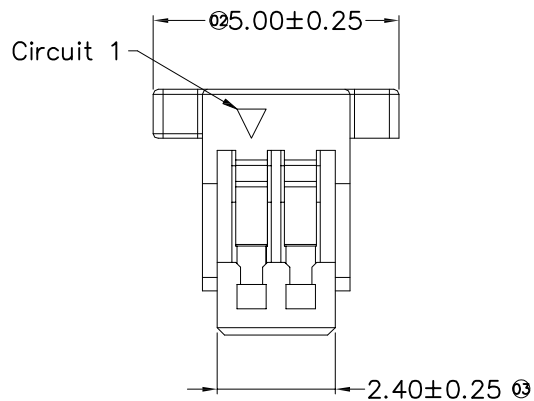

A1002 H X-02-N0 XX XX  
 ① ② ③ ④ ⑤ ⑥ ⑦

- ① SeriesNo.
- ② Category : H-HSG
- ③ WeldingBoardAngle ; Blank-ordinary
- ④ RowNo.-Pin No.: 02-02P
- ⑤ Material : N0-PA66 94V-0
- ⑥ HF- Halogen Free ; Blank- Halogen
- ⑦ Color: Blank-natural color

					<b>GENERAL TOLERANCE</b> .X ±0.30 .XX ±0.20 .XXX ±0.10 X.* ±2° PROJECT 				<b>GYA Connectors</b> 东莞市国亚电子有限公司 Dong Guan Guo Ya Connectors co.,ltd.				<b>PARTNO.</b> A1002H-02P-NOHF <b>TITLE</b> 1.00 mm Crimp Style Conmctctors									
					<b>APPROVAL</b> Yangzhengguo		<b>CHECK</b> Yangzhengyi		<b>DRAWN</b> Lvtiansheng		<b>DATE</b> 2016/08/26		<b>UNIT</b> mm		<b>SCALE</b> 1:1		<b>SHEET</b> 1/1		<b>REV</b> A0		<b>NUMBER</b> A-022	
<b>DATE</b>	<b>REV</b>	<b>ECN NO</b>	<b>DESCRIPTION</b>	<b>MODIFY</b>	<b>APPROVAL</b>																	

RoHS

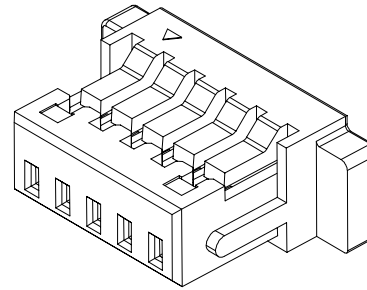
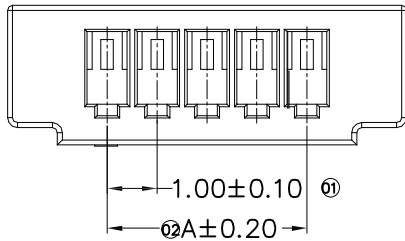

■ Specifications :

- Voltage rating: 50V AC / DC
- Current rating: 1A AC / DC
- Withstanding voltage: 500V AC/minute
- Temperature range: -25° ~+85°
- Insulation resistance: ≥100MΩ
- Contact resistance: ≤20mΩ
- After environmental testing: ≤40mΩ

- Suitable GYA Terminal: A1002T
- Mates With GYA Wafer: A1002W

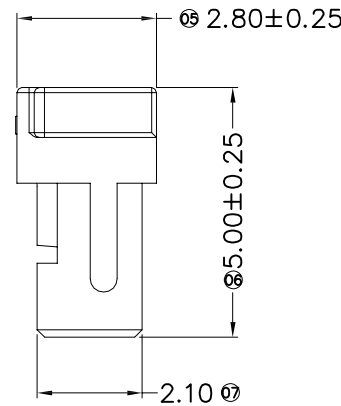
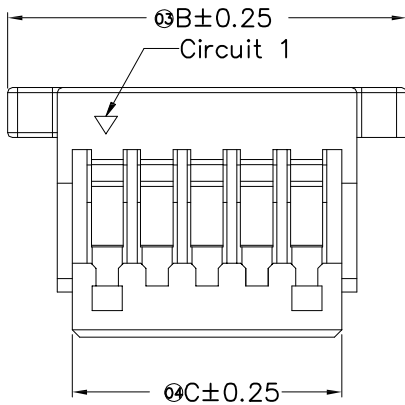

A1002 H X-XX-NO XX XX  
 ① ② ③ ④ ⑤ ⑥ ⑦

① Series No.

② Category : H-HSG

③ WeldingBoardAngle: Blank-ordinary

④ Row No.-Pin No.: XX-Q2P~24P

⑤ Material : NO-PA66 94V-0

⑥ HF- Halogen Free ; Blank- Halogen

⑦ Color: Blank-natural color

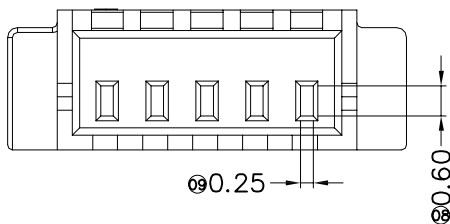

Poles	Dimensions(mm)			Poles	Dimensions(mm)		
	A	B	C		A	B	C
02	1.00	5.00	2.40	13	12.00	16.00	13.40
03	2.00	6.00	3.40	14	13.00	17.00	14.40
04	3.00	7.00	4.40	15	14.00	18.00	15.40
05	4.00	8.00	5.40	16	15.00	19.00	16.40
06	5.00	9.00	6.40	17	16.00	20.00	17.40
07	6.00	10.00	7.40	18	17.00	21.00	18.40
08	7.00	11.00	8.40	19	18.00	22.00	19.40
09	8.00	12.00	9.40	20	19.00	23.00	20.40
10	9.00	13.00	10.40	22	21.00	25.00	22.40
11	10.00	14.00	11.40	24	23.00	27.00	24.40
12	11.00	15.00	12.40				

GENERAL TOLERANCE

.X ±0.30

.XX ±0.20

.XXX ±0.10

X.\* ±2°

PROJECT



东莞市国亚电子有限公司  
 Dong Guan Guo Ya Connectors co., Ltd.

PARTNO.  
 A1002H-XX-NOHF

TITLE  
 1.00 mm Crimp Style Connectors

APPROVAL CHECK DRAWN DATE

Yangzhengguo Yangzhengyi Lviansheng 2016/08/26

UNIT SCALE SHEET REV NUMBER  
 mm 1:1 1/1 A0 A-022

DATE REV ECN NO DESCRIPTION MODIFY APPROVAL

1 2 3 4 5 6 7 8

RoHS

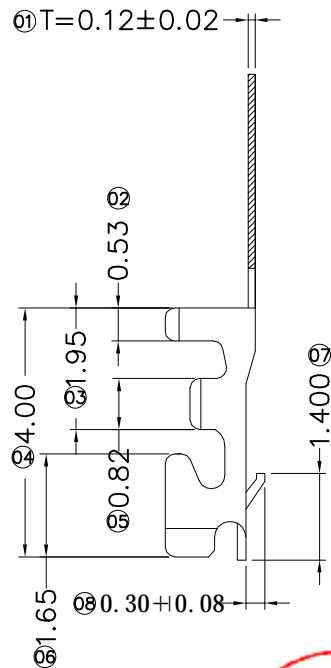
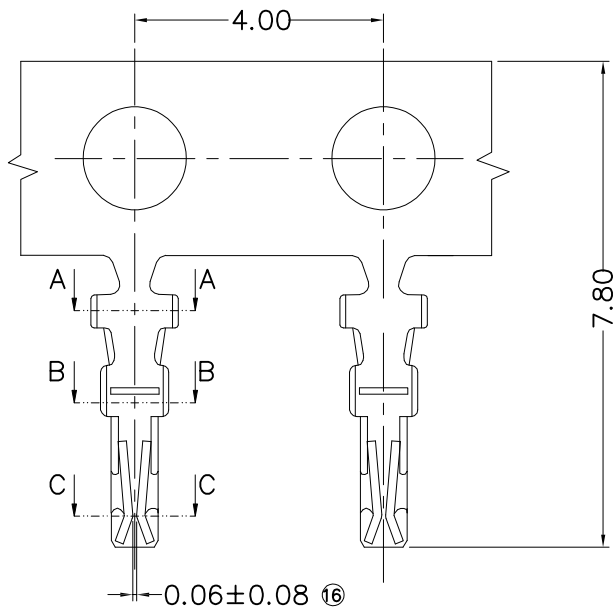

■ Specifications :

- Voltage rating: 50V AC / DC
- Current rating: 1A AC / DC
- Withstanding voltage: 500V AC/minute
- Temperature range: -25° ~ +85°
- Insulation resistance: ≥100MΩ
- Contact resistance: ≤20mΩ
- After environmental testing : ≤40mΩ

A1002 T X-P XX X-X  
① ② ③ ④ ⑤ ⑥ ⑦

- ① Series Number
- ② Category: T-terminal
- ③ Shape: Blank-ordinary
- ④ Material: P-Phosphor bronze
- ⑤ Plating Code:  
V\*\*-All Gold-Plated; \*01-Gold Flash; \*03-3u" Au  
SN-Bright tin plating
- ⑥ Plating method:  
Blank-Stamping before plating  
B-Plating before stamping
- ⑦ MoldNo./Mark/Special No.

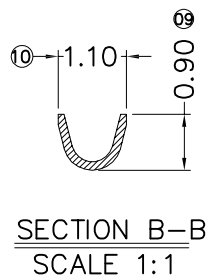
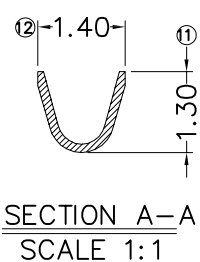
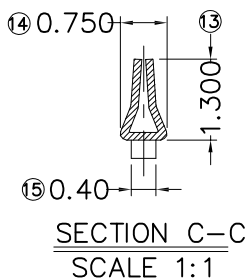

A1002T-PV03				Stamping Before Plating: 30u" Ni; Whole Gold : 3u" Mn.	
A1002T-PV01	Phosphor Bronze	AWG#28-32	0.80mm(Max)	Stamping Before Plating: 30u" Ni; Whole Gold : Gold Flash	A1002H
A1002T-PSN				Stamping Before Plating: 30u" Ni; 70u" Sn	
PART NO	Material	Wire Range	Insulation O.D.	Finish	Used In GYA Housing

GENERAL TOLERANCE	
.X	±0.30
.XX	±0.20
.XXX	±0.10
X.*	±2°

**GYA**  
Connectors

东莞市国亚电子有限公司  
Dong Guan Guo Ya Connectors co., Ltd.

PARTNO.  
A1002T-PXXX

TITLE  
1.00 mm Crimp Style Connectors

APPROVAL	CHECK	DRAWN	DATE
Yangzhengguo	Yangzhengyi	Lviansheng	2016/08/26

UNIT	SCALE	SHEET	REV	NUMBER
mm	1:1	1/1	A0	A-014

DATE	REV	ECN NO	DESCRIPTION	MODIFY	APPROVAL
------	-----	--------	-------------	--------	----------

1 | 2 | 3 | 4 | 5 | 6 | 7 | 8

RoHS

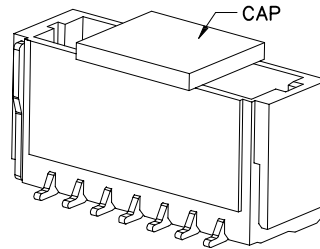
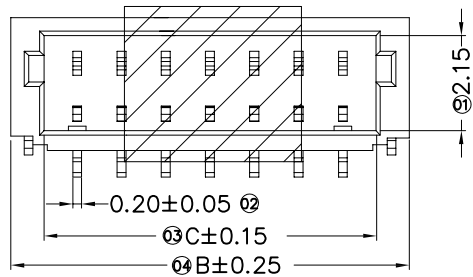

■ Specifications :

- Voltage rating: 50V AC / DC
- Current rating: 1A AC / DC
- Withstanding voltage: 500V AC/minute
- Temperature range: -25° ~+85°
- Insulation resistance: ≥100MΩ
- Contact resistance: ≤20mΩ
- After environmental testing: ≤40mΩ
- Material(Pin And Solder Tabs): Phosphor Bronze
- Finish(Solder Tabs): Matte Tin Plating
- Mates With GYA Housing: A1002H

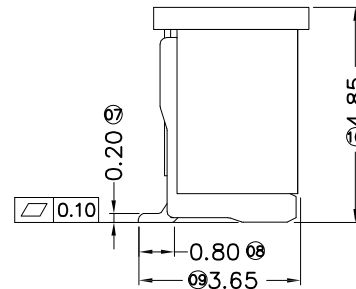
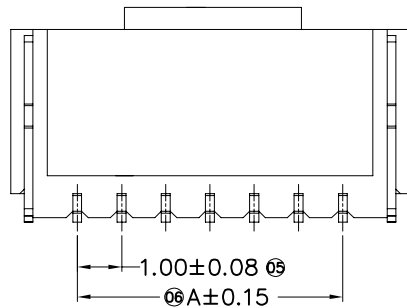

A1002 W V S-XX LP XX XX  
 ① ② ③ ④ ⑤ ⑥ ⑦ ⑧

- ① Series No.
- ② Category : W-wafer
- ③ Connector type: V-180°
- ④ Mounting type: S-SMT
- ⑤ Row No.-Pin No per row: XX-02P~20P
- ⑥ Plastic material : LP-LCP 94V-0
- ⑦ Plating Code: SW-Matte Tin plating (Tin: 70u Mn)  
V01-All Gold Flash
- ⑧ Color: Blank-Natural color

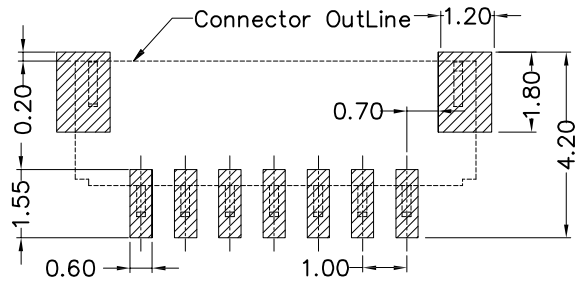

Recommended P.C.B Layout  
 General Tolerance±0.05



Poles	Dimensions(mm)			Poles	Dimensions(mm)		
	A	B	C		A	B	C
02	1.00	4.00	2.50	11	10.00	13.00	11.50
03	2.00	5.00	3.50	12	11.00	14.00	12.50
04	3.00	6.00	4.50	13	12.00	15.00	13.50
05	4.00	7.00	5.50	14	13.00	16.00	14.50
06	5.00	8.00	6.50	15	14.00	17.00	15.50
07	6.00	9.00	7.50	16	15.00	18.00	16.50
08	7.00	10.00	8.50	18	17.00	20.00	18.50
09	8.00	11.00	9.50	20	19.00	22.00	20.50
10	9.00	12.00	10.50				

					GENERAL TOLERANCE .X ±0.30 .XX ±0.20 .XXX ±0.10 X.* ±2° PROJECT				<b>GYA</b> 东莞市国亚电子有限公司 Connectors Dong Guan Guo Ya Connectors co.,ltd.				PARTNO. A1002WVS-XX-LPXXX TITLE 1.00mm Crimp Style Connectors			
DATE	REV	ECN NO	DESCRIPTION	MODIFY	APPROVAL	APPROVAL	CHECK	DRAWN	DATE	UNIT	SCALE	SHEET	REV	NUMBER		
						Yangzhengguo	Yangzhengyi	Lvtiansheng	2016/08/26	mm	1:1	1/1	A0	A-084		

RoHS

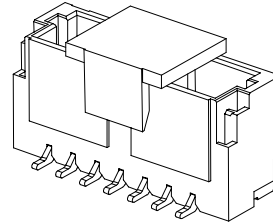

- Specifications :
- Voltage rating: 50V AC / DC
  - Current rating: 1A AC / DC
  - Withstanding voltage: 500V AC/minute
  - Temperature range: -25° ~ +85°
  - Insulation resistance: ≥100MΩ
  - Contact resistance: ≤20mΩ
  - After environmental testing: ≤40mΩ

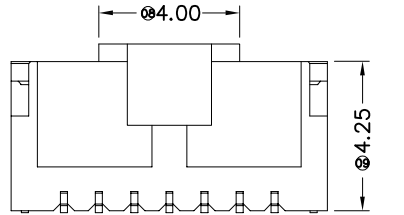
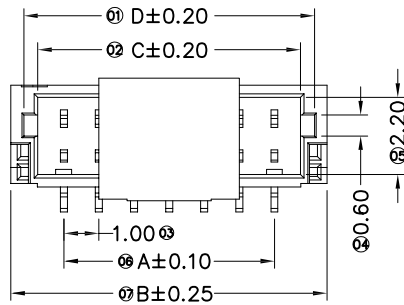

02P~09P Without Gate Location groove

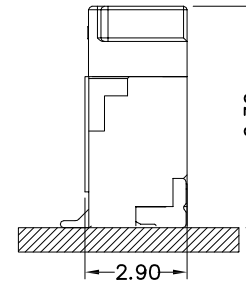
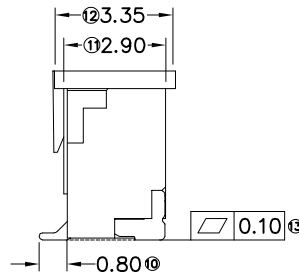

A1002 W V S-XX X- XX XXX XX  
① ② ③ ④ ⑤ ⑥ ⑦ ⑧ ⑨

- ① Series No.
- ② Category : W-wafer
- ③ Connector type: V- Straight 180°
- ④ Mounting type: S-SMT
- ⑤ Row No.-Pin No per row: XX-02P~24P
- ⑥ Special No. C-Have CAP  
HF-Halogen Free
- ⑦ Plastic Material ; 4T-PA4T 94V-0;  
9T-PA9T 94V-0
- ⑧ Plating Code: SW-Matte tin plating  
Sn: 100u" Min ; Ni: 50u" Min.
- ⑨ Color: Blank-Natural Color

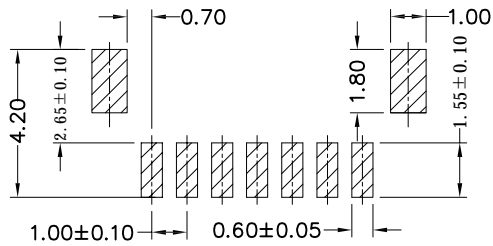

Recommad PCB Layout

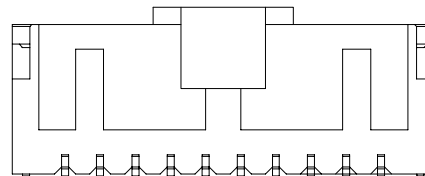

10P With Gate Location groove and Other Pin Without Gate Location groove

Poles	Dimensions(mm)				Poles	Dimensions(mm)			
	A	B	C	D		A	B	C	D
02	1.00	4.00	2.48	3.28	12	11.00	14.00	12.48	13.28
03	2.00	5.00	3.48	4.28	13	12.00	15.00	13.48	14.28
04	3.00	6.00	4.48	5.28	14	13.00	16.00	14.48	15.28
05	4.00	7.00	5.48	6.28	15	14.00	17.00	15.48	16.28
06	5.00	8.00	6.48	7.28	16	15.00	18.00	16.48	17.28
07	6.00	9.00	7.48	8.28	17	16.00	19.00	17.48	18.28
08	7.00	10.00	8.48	9.28	18	17.00	20.00	18.48	19.28
09	8.00	11.00	9.48	10.28	19	18.00	21.00	19.48	20.28
10	9.00	12.00	10.48	11.28	20	19.00	22.00	20.48	21.28
11	10.00	13.00	11.48	12.28	24	23.00	26.00	24.45	25.28

A1002WS-XXCHF-4TSW	Style 4T UL 94V-0 Halogen Free	LCP UL94V-0 Color : Black	Phosphor Bronze	Brass	Matte Tin-Plated	A1002H
A1002WS-XXCHF-9TSW	Style 9T UL 94V-0 Halogen Free					
PART NO	Housing Material	Cap Material	PIN Material	Solder Tab Material	Finish(Pin And Solder Tabs)	Mates With GYA Housing

GENERAL TOLERANCE	
.X	±0.30
.XX	±0.20
.XXX	±0.10
X.'	±2'



东莞市国亚电子有限公司  
Dong Guan Guo Ya Connectors co.,ltd.

APPROVAL	CHECK	DRAWN	DATE
Yangzhengguo	Yangzhengyi	Lvtiansheng	2016/08/26

PARTNO. A1002WVS-XXCHF-XTSW				
TITLE 1.00mm Crimp Style Connectors				
UNIT	SCALE	SHEET	REV	NUMBER
mm	1:1	1/1	A0	A-000

DATE	REV	ECN NO	DESCRIPTION	MODIFY	APPROVAL
1		2		4	



RoHS

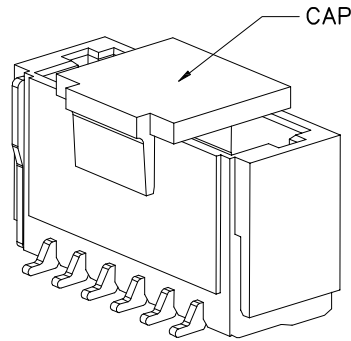
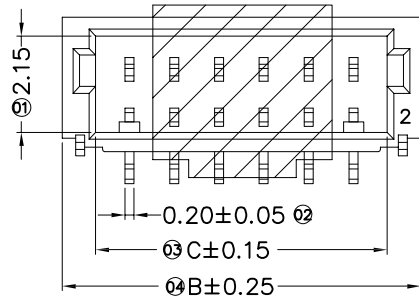

Specifications :

- Voltage rating: 50V AC / DC
- Current rating: 1.0A AC / DC
- Withstanding voltage: 500V AC/minute
- Temperature range: -25° ~+85°
- Insulation resistance: ≥100MΩ
- Contact resistance: ≤20mΩ
- After environmental testing: ≤40mΩ
- Material (Pin ): Phosphor Bronze
- Material (Solder Tabs) : Brass
- Mates With GYA Housing: A1002H

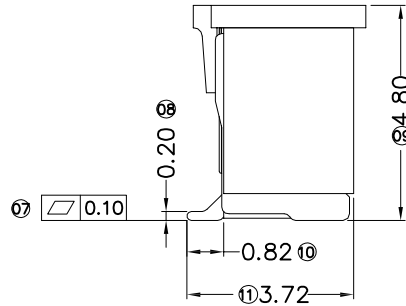
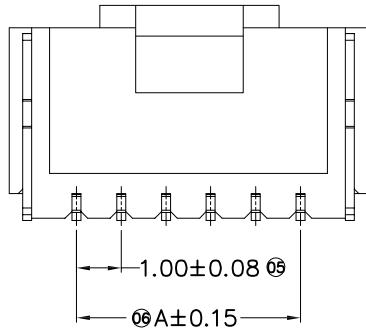

A1002W VS -1xXX -XX X P XX C X 001F  
 ① ② ③ ④ ⑤ ⑥ ⑦ ⑧ ⑨ ⑩ ⑪ ⑫ ⑬

- ① Series No.
- ② Category : W-wafer
- ③ Connector type : V- Straight 180°
- ④ Mounting type: S-SMT
- ⑤ Row No. -Pin No per row: 1xXX-Single Row 1xXXPin.
- ⑥ Plastic material: 4T- PA4T LP-LCP 94V-0
- ⑦ Color : N-Natural B-Black
- ⑧ Metal material: P-Phosphor Bronze
- ⑨ Plating Code: 04-Matte Tin 10-Gold Flash
- ⑩ Packing: C-Reel With CAP
- ⑪ RoHS/HF code: H-Halogen-free R-RoHS
- ⑫ Sequence Number: 001
- ⑬ Special code: F-Other Connectors

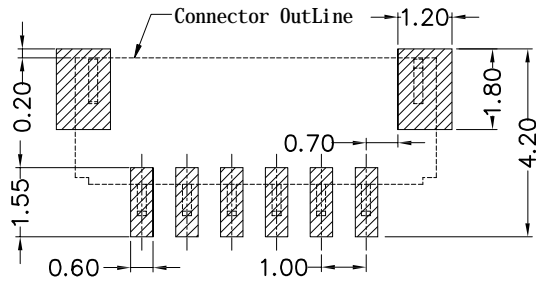

Recommended P.C.B Layout  
 General Tolerance ±0.05



Poles	Dimensions(mm)			Poles	Dimensions(mm)		
	A	B	C		A	B	C
02	1.00	4.00	2.50	10	9.00	12.00	10.50
03	2.00	5.00	3.50	11	10.00	13.00	11.50
04	3.00	6.00	4.50	12	11.00	14.00	12.50
05	4.00	7.00	5.50	13	12.00	15.00	13.50
06	5.00	8.00	6.50	14	13.00	16.00	14.50
07	6.00	9.00	7.50	15	14.00	17.00	15.50
08	7.00	10.00	8.50	16	15.00	18.00	16.50
09	8.00	11.00	9.50				

GENERAL TOLERANCE

.X ±0.30

.XX ±0.20

.XXX ±0.10

X.\* ±2°

PROJECT

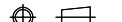

东莞市国亚电子有限公司  
 Dong Guan Guo Ya Connectors co., l td.

PARTNO.

A1002WS-1xXX-XXXPXXC001F

TITLE

1.00mm Crimp Style Connectors

APPROVAL

Yangzhengguo

CHECK

Yangzhengyi

DRAWN

Lvtiansheng

DATE

2016/08/26

UNIT SCALE SHEET REV NUMBER

mm 1:1 1/1 A0 A-082

DATE	REV	ECN NO	DESCRIPTION	MODIFY	APPROVAL
1					
2					
3					

RoHS

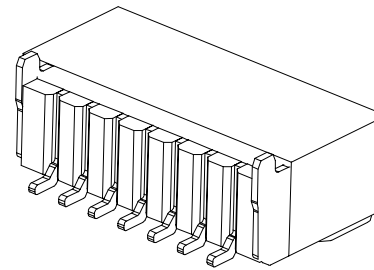
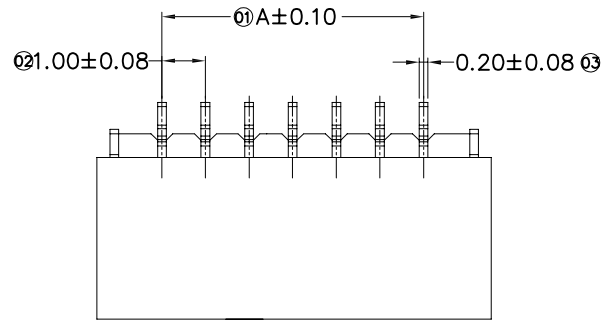

■ Specifications :

- Voltage rating: 50V AC / DC
- Current rating: 1A AC / DC
- Withstanding voltage: 500V AC/minute
- Temperature range: -25° ~ +85°
- Insulation resistance: ≥100MΩ
- Contact resistance: ≤20mΩ
- After environmental testing : ≤40mΩ

- Material (Pin and Solder Tabs) : Phosphor Bronze
- Finish (Solder Tabs): Matte Tin Plating
- Mates With GYA Housing: A1002H

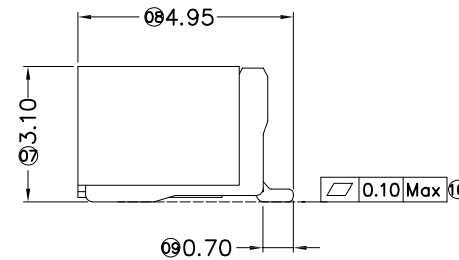
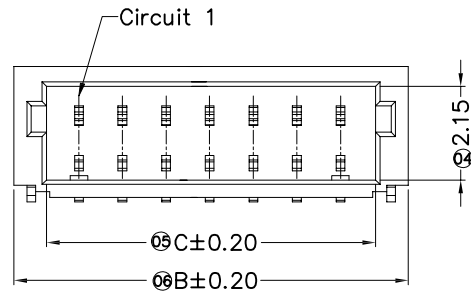

A1002 W R S-XX-LP XX XX  
 ① ② ③ ④ ⑤ ⑥ ⑦ ⑧

- ① Series No.
- ② Category : W-wafer
- ③ Connector type: R-90°
- ④ Mounting type: S-SMT
- ⑤ Row No.-Pin No per row: XX-02P~20P
- ⑥ Plastic Material : LP-LCP 94V-0
- ⑦ Planting Code:
- ⑧ V01-Gold Flash  
SW-Matte Tin plating
- ⑨ Color: Blank-natural color  
BK-Black

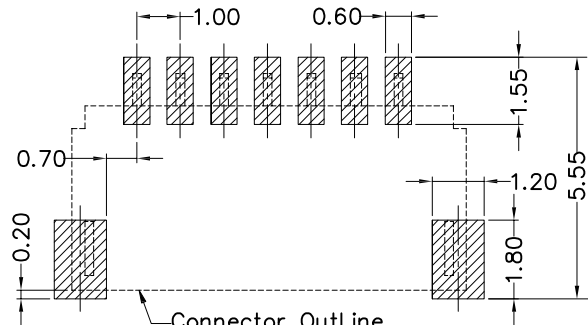

Connector Outline  
 Recommended P.C.B Layout  
 General Tolerance ±0.05



Poles	Dimensions(mm)			Poles	Dimensions(mm)		
	A	B	C		A	B	C
02	1.00	4.00	2.50	10	9.00	12.00	10.50
03	2.00	5.00	3.50	11	10.00	13.00	11.50
04	3.00	6.00	4.50	12	11.00	14.00	12.50
05	4.00	7.00	5.50	13	12.00	15.00	13.50
06	5.00	8.00	6.50	14	13.00	16.00	14.50
07	6.00	9.00	7.50	15	14.00	17.00	15.50
08	7.00	10.00	8.50	16	15.00	18.00	16.50
09	8.00	11.00	9.50	20	19.00	22.00	20.50

GENERAL TOLERANCE					APPROVAL				PARTNO.				
.X ±0.30					<b>GYA</b> 东莞市国亚电子有限公司 Dong Guan Guo Ya Connectors co.,l td. APPROVAL CHECK DRAWN DATE Yangzhengguo Yangzhengyi Lviansheng 2016/08/26				A1002WRS-XX-LPXXXX				
.XX ±0.20									TITLE				
.XXX ±0.10									1.00 mm Crimp Style Connectors				
X.* ±2°									UNIT SCALE SHEET REV NUMBER				
DATE	REV	ECN NO	DESCRIPTION	MODIFY	APPROVAL	PROJECT				mm 1:1 1/1 AO A-084			
1		2		3		PROJECT				8			

RoHS

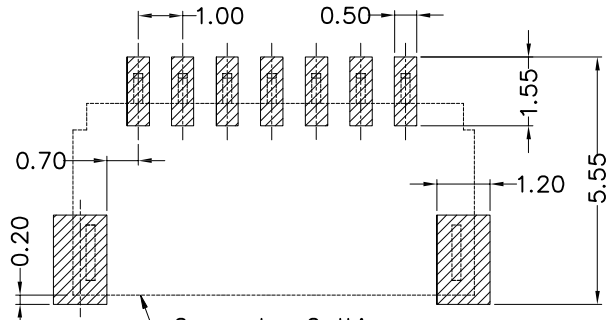
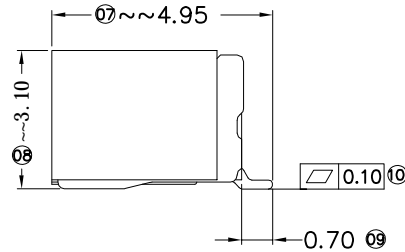
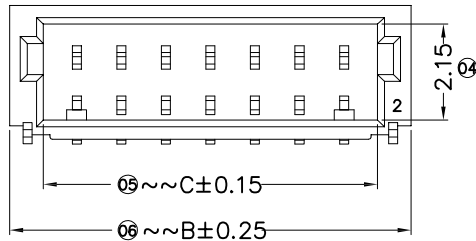
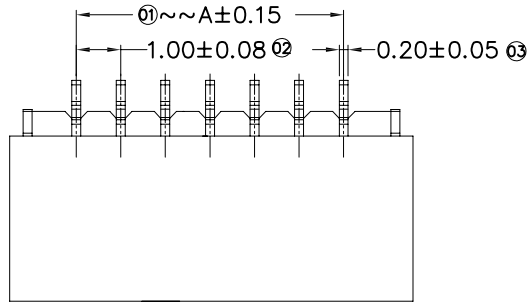

- Specifications :
- Voltage rating: 50V AC / DC
  - Current rating: 1A AC / DC
  - Withstanding voltage: 500V AC/minute
  - Temperature range: -25° ~ +85°
  - Insulation resistance: ≥100MΩ
  - Contact resistance: ≤20mΩ
  - After environmental testing: ≤40mΩ
  - Material (Pin ): Phosphor Bronze
  - Material (Solder Tabs) : Brass
  - Mates With GYA Housing: A1002H

A1002 W R S -1xXX -XX X P XX R X 001F  
 ① ② ③ ④ ⑤ ⑥ ⑦ ⑧ ⑨ ⑩ ⑪ ⑫ ⑬

- ① Series No.
- ② Category : W-wafer
- ③ Connector Type R- Right Angle 90°
- ④ Mounting Type: S-SMT
- ⑤ Row No. -Pin No per row: 1xXX-Single Row 1xXXPin.
- ⑥ Plastic material: 4T- PA4T LP-LCP 94V-0
- ⑦ Color : N-Natural B-Black
- ⑧ Metal material: P-Phosphor Bronze
- ⑨ Plating Code: 04-Matte Tin 10-Gold Flash
- ⑩ Packing: R-Reel
- ⑪ RoHS/HF Code: H-Halogen-free R-RoHS
- ⑫ Water code: 001
- ⑬ Special code: F-Other Connectors

Poles	Mating force(Kgf Max)		Poles	Mating force(Kgf Max)	
	First Insertion	30th Withdrawal		First Insertion	30th Withdrawal
02	2.0	0.32	09	4.0	0.50
03	2.0	0.35	10	4.0	0.50
04	2.0	0.35	11	5.0	0.60
05	3.0	0.40	12	5.0	0.60
06	3.0	0.40	13	5.0	0.60
07	3.0	0.40	14	6.0	0.70
08	4.0	0.50	15	6.0	0.70

Poles	Dimensions(mm)			Poles	Dimensions(mm)		
	A	B	C		A	B	C
02	1.00	4.00	2.50	10	9.00	12.00	10.50
03	2.00	5.00	3.50	11	10.00	13.00	11.50
04	3.00	6.00	4.50	12	11.00	14.00	12.50
05	4.00	7.00	5.50	13	12.00	15.00	13.50
06	5.00	8.00	6.50	14	13.00	16.00	14.50
07	6.00	9.00	7.50	15	14.00	17.00	15.50
08	7.00	10.00	8.50	16	15.00	18.00	16.50
09	8.00	11.00	9.50				

GENERAL TOLERANCE	
.X	±0.30
.XX	±0.20
.XXX	±0.10
X.*	±2°



东莞市国亚电子有限公司  
 Dong Guan Guo Ya Connectors co.,ltd.

APPROVAL	CHECK	DRAWN	DATE
Yangzhengguo	Yangzhengyi	Lvtiansheng	2016/08/26

PARTNO.  
 A1002WRS-1xXX-XXXPRX001F

TITLE				
Pitch 1.0mm 180° SMT Wafer				
UNIT	SCALE	SHEET	REV	NUMBER
mm	1:1	1/1	A0	A-082

DATE	REV	ECN NO	DESCRIPTION	MODIFY	APPROVAL
1					
2					
3					
4					
5					