

RoHS

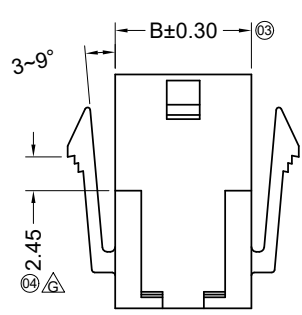

With Ears

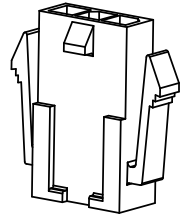
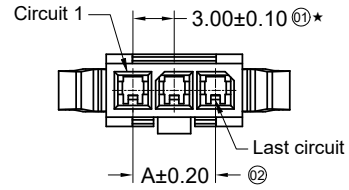
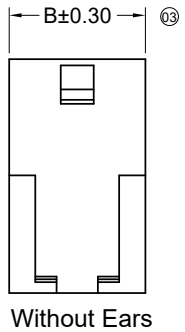
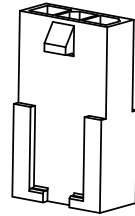
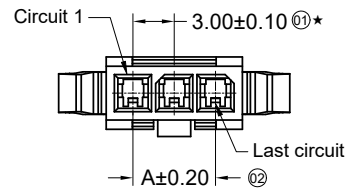
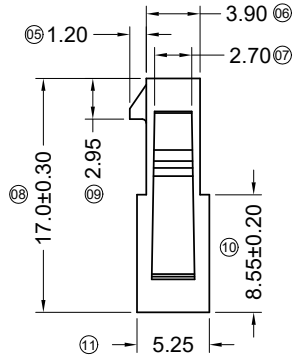

Without Ears

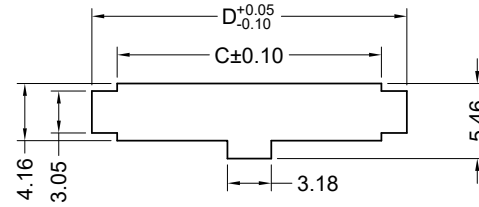
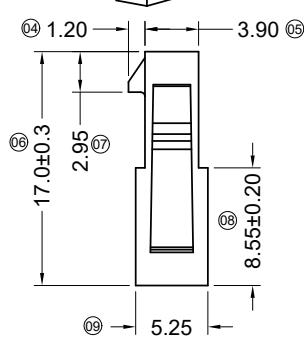

With Ears Recommended P.C.B Layout  
Thick=1.60~2.40±0.05mm

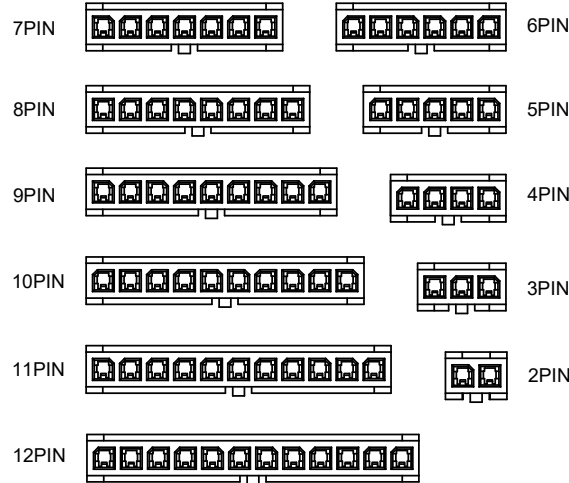

■ Specifications :

- Voltage rating: 250V AC / DC
- Current rating: 5A Max AC / DC
- Withstanding voltage: 1000V AC/minute
- Temperature range: -40°C~+105°C
- Insulation resistance: ≥1000MΩ
- Contact resistance: ≤10mΩ
- After environmental testing: ≤20mΩ
- Mates With GYA Housing: 3025HM
- Suitable GYA Terminal: 3025TM
- "★"Critical dimension

3025 H F-XX X - N0 XX

① ② ③ ④ ⑤ ⑥ ⑦

- ① Series No.
- ② Category: H-HSG
- ③ Connector Type: F-Female HSG
- ④ Row No.-Pin No Per Row: XX-02P~12P
- ⑤ Special No.: -Without Ears  
G-With Ears
- ⑥ Material: N0-PA66 94V-0
- ⑦ Color: Blank-Black ; WH-White

Poles	Dimensions(mm)			
	A	B	C	D
02	3.00	6.90	7.21	10.89
03	6.00	9.90	10.21	13.89
04	9.00	12.90	13.21	16.89
05	12.00	15.90	16.21	19.89
06	15.00	18.90	19.21	22.89
07	18.00	21.90	22.21	25.89
08	21.00	24.90	25.21	28.89
09	24.00	27.90	28.21	31.89
10	27.00	30.90	31.21	34.89
11	30.00	33.90	34.21	37.89
12	33.00	36.90	37.21	40.89



					GENERAL TOLERANCE		东莞市国亚电子有限公司 DONGGUO GUOYA ELECTRONICS CO.,LTD				PART NO. 3025HF-XXX-N0				
					.X ±0.30						APPROVAL				TITLE 3.00 mm Crimp Style Connectors
					.XX ±0.20		CHECK				UNIT				
					.XXX ±0.10		DRAWN				SCALE				
					X.° ±2°		DATE				SHEET				
					PROJECT		YANG				REV				
							TIAN				NUMBER				
DATE	REV	ECN NO.	DESCRIPTION	MODIFY	APPROVAL	2007/05/03				mm					
											1 : 1				
											1/1				
											A0				
											A-022				

RoHS

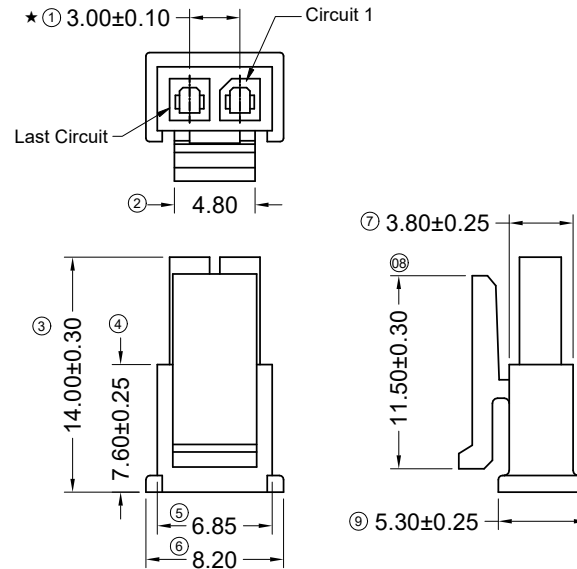
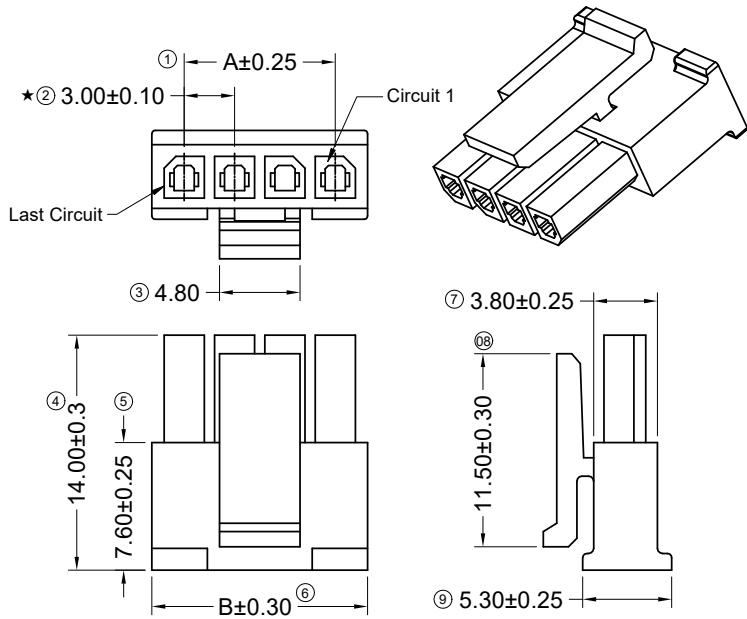

2PIN

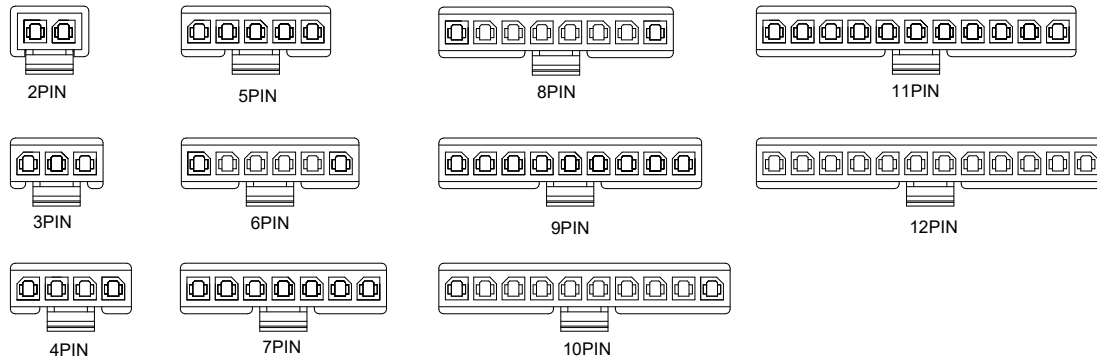

Specifications :

- Voltage rating: 250V AC / DC
- Current rating: 5A Max AC / DC
- Withstanding voltage: 1000V AC/minute
- Temperature range: -40°C~+105°C
- Insulation resistance: ≥1000MΩ
- Contact resistance: ≤10mΩ
- After environmental testing: ≤20mΩ
- Suitable GYA Terminal: 3025TF Mates
- With GYA Wafer: 3025W
- "\*"Critical dimension

3025 H M-XX X- N0 XX

① ② ③ ④ ⑤ ⑥ ⑦

- ① Series No.
- ② Category: H-HSG
- ③ Connector Type: M-Male HGS
- ④ Row No.-Pin No Per Row: XX-02P~12P
- ⑤ Special No.: Blank-Ordinary
- ⚠ ⑥ Material: N0-PA66 94V-0  
N2-PA66 94V-2
- ⑦ Color: Blank-Black



Poles	Dimensions (mm)		Poles	Dimensions (mm)	
	A	B		A	B
03	6.00	9.85	08	21.00	24.85
04	9.00	12.85	09	24.00	27.85
05	12.00	15.85	10	27.00	30.85
06	15.00	18.85	11	30.00	33.85
07	18.00	21.85	12	33.00	36.85

					GENERAL TOLERANCE		<b>东莞市国亚电子有限公司</b> DONGGUO GUOYA ELECTRONICS CO.,LTD				PART NO. 3025HM-XX-XX				
					.X ±0.30						TITLE				
					.XX ±0.20		3.00 mm Crimp Style Connectors								
					.XXX ±0.10		APPROVAL		CHECK	DRAWN	DATE	UNIT			
					X.° ±2°		YANG		TIAN	TIAN	2007/05/03	SCALE	SHEET	REV	NUMBER
DATE	REV	ECN NO.	DESCRIPTION	MODIFY	APPROVAL	PROJECT					mm	1:1	1/1	A0	A-022

RoHS

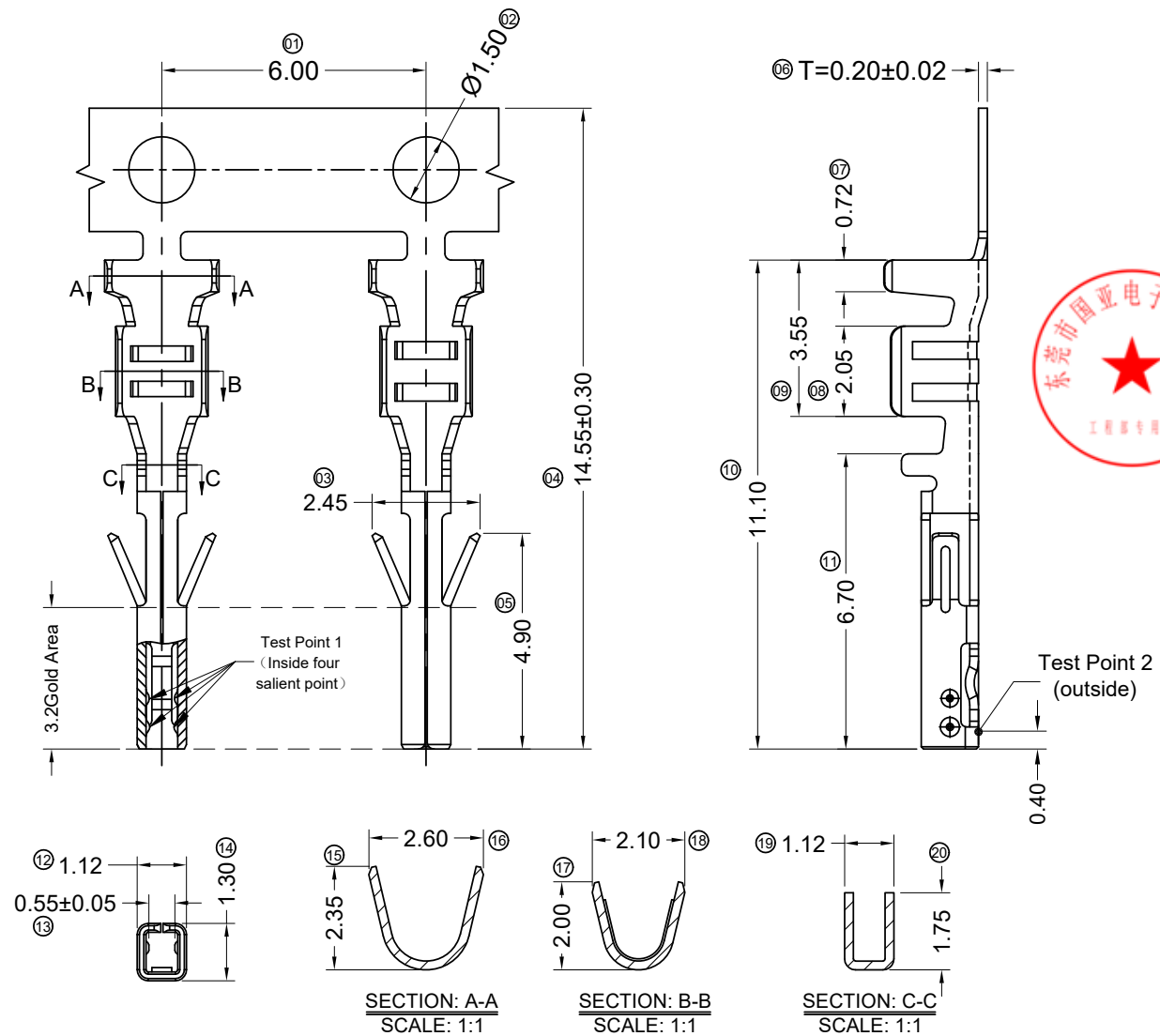

- Specifications :
- Voltage rating: 250V AC / DC
  - Current rating: 5A Max AC / DC
  - Withstanding voltage: 1000V AC/minute
  - Temperature range: -40°C~+105°C
  - Insulation resistance: ≥1000MΩ
  - Contact resistance: ≤10mΩ
  - After environmental testing: ≤20mΩ
- 
- Wire Size: AWG#20~24
  - Insulation O.D.: 1.85mm Max
  - Used In GYA Housing: 3025HM

3025 T F-P XX X-V  
 ⑪ ⑫ ⑬ ⑭ ⑮ ⑯ ⑰

- ⑪ Series Number
- ⑫ Category: T-terminal
- ⑬ Shape: F-Female Terminal
- ⑭ Material: P-Phosphor bronze
- ⑮ Plating Code:
  - G30- Contact point gold 30u "(inside test piont 1)  
Gold area 1u"(outside test piont 2)  
Other area Ni 30u" Min
  - G15- Contact point gold 15u "(inside test piont 1)  
Gold area 1u"(outside test piont 2)  
Other area Ni 30u" Min
  - G01-Contact Area Gold Flash (outside test piont 2)  
SN-Bright tin plating(outside test piont 2)
- ⑯ Plating method: Blank-Stamping before plating
- ⑰ V- Convex hull limit

					GENERAL TOLERANCE		东莞市国亚电子有限公司 DONGGUO GUOYA ELECTRONICS CO.,LTD				PART NO. 3025TF-PXXX-V				
					.X ±0.30						TITLE				
					.XX ±0.20		APPROVAL				3.00mm Crimp Style Connectors				
					.XXX ±0.10		CHECK				UNIT				
					X.° ±2°		DRAWN				SCALE				
					PROJECT		DATE				SHEET				
DATE					REV		YANG				REV				
ECN NO.					DESCRIPTION		TIAN				NUMBER				
MODIFY					APPROVAL		TIAN				mm				
							2017/09/14				1:1				
											1/1				
											A0				
											A-000				

RoHS

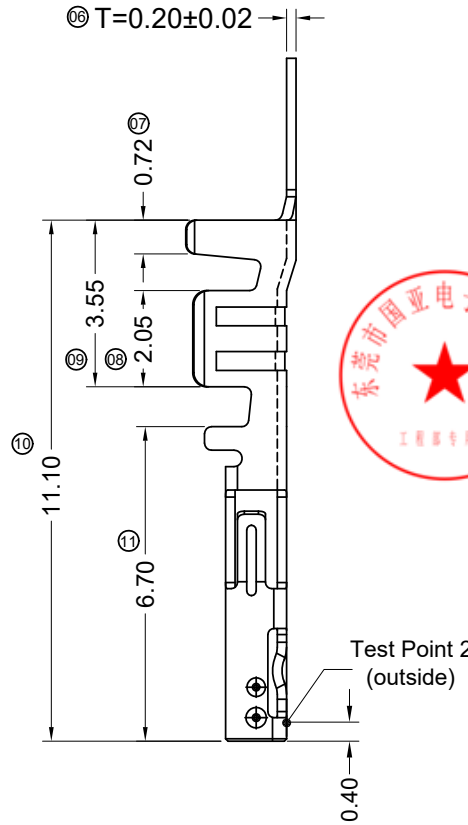
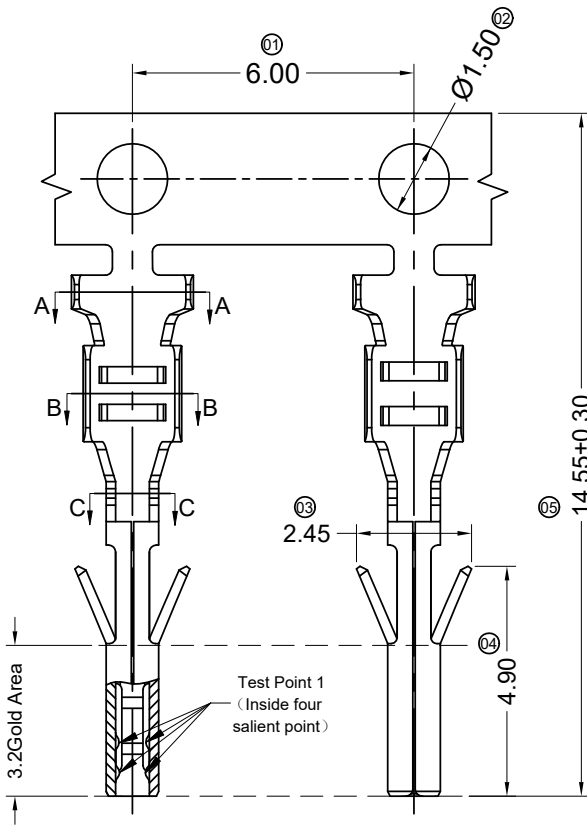

- Specifications :
- Voltage rating: 250V AC / DC
  - Current rating: 5A Max AC / DC
  - Withstanding voltage: 1000V AC/minute
  - Temperature range: -40°C~+105°C
  - Insulation resistance: ≥1000MΩ
  - Contact resistance: ≤10mΩ
  - After environmental testing: ≤20mΩ

- Wire Size: AWG#20~22(0.5~0.35mm<sup>2</sup>)
- Insulation O.D.: 1.85mm Max
- Used In GYA Housing: 3025HM
- "\*"Critical dimension

3025 T F-P XX X- V

①②③④⑤⑥⑦

- ① Series Number
- ② Category: T-terminal
- ③ Shape: F-Female Terminal
- ④ Material: P-Phosphor bronze
- ⑤ Plating Code:
  - G30- Contact point gold 30u "(inside test piont 1)  
Gold area 1u"(outside test piont 2)  
Other area Ni 30u" Min
  - G15- Contact point gold 15u "(inside test piont 1)  
Gold area 1u"(outside test piont 2)  
Other area Ni 30u" Min
  - G01-Contact Area Gold Flash (outside test piont 2)  
SN-Bright tin plating(outside test piont 2)
- ⑥ Plating method: Blank-Stamping before plating
- ⑦ V- Convex hull limit

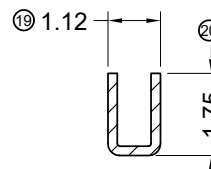
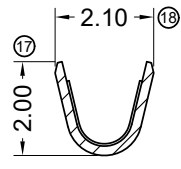
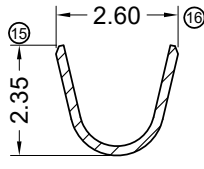
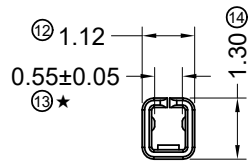

					GENERAL TOLERANCE		东莞市国亚电子有限公司 DONGGUO GUOYA ELECTRONICS CO.,LTD				PART NO. 3025TF-PXXX-V				
					.X ±0.30						TITLE				
					.XX ±0.20		APPROVAL				3.00mm Crimp Style Connectors				
					.XXX ±0.10		CHECK				UNIT				
					X.° ±2°		DRAWN				SCALE				
					PROJECT		DATE				SHEET				
					PROJECT		2017/09/14				REV				
					PROJECT		YANG				NUMBER				
					PROJECT		TIAN				mm				
					PROJECT		TIAN				1:1				
					PROJECT		2017/09/14				1/1				
					PROJECT		2017/09/14				A0				
					PROJECT		2017/09/14				A-000				
DATE	REV	ECN NO.	DESCRIPTION	MODIFY	APPROVAL										

1 2 3 4 5 6 7 8

RoHS

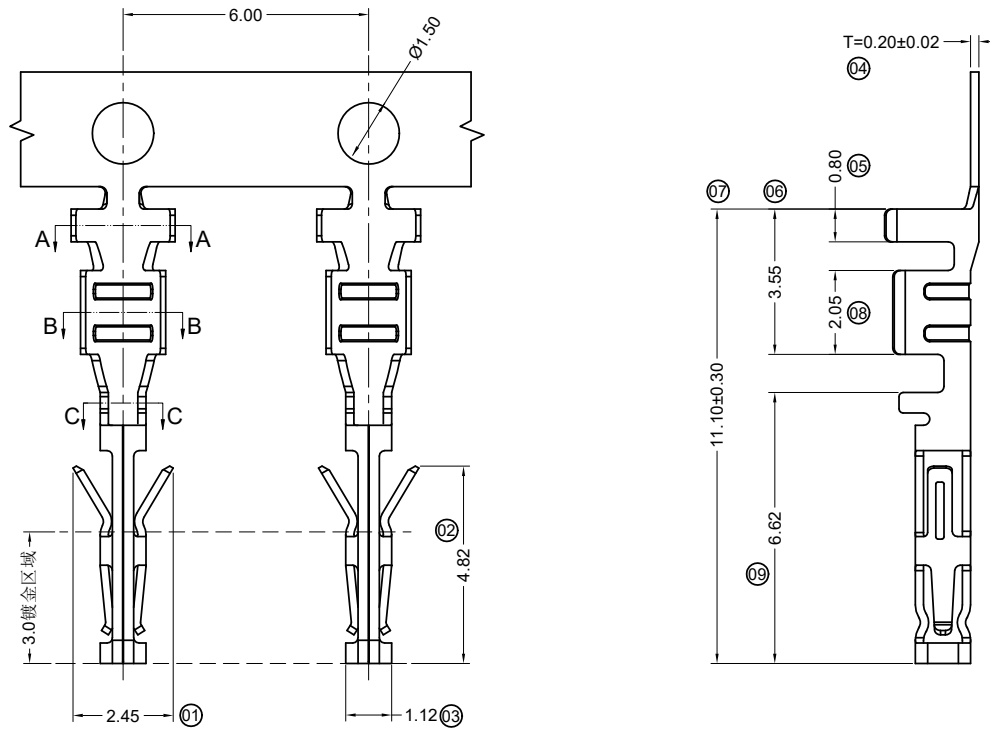

■ Specifications :

- Voltage rating: 250V AC / DC
- Current rating: 5A Max AC / DC
- Withstanding voltage: 1000V AC/minute
- Temperature range: -40°C~+105°C
- Insulation resistance: ≥1000MΩ
- Contact resistance: ≤10mΩ
- After environmental testing: ≤20mΩ
- Wire Range: AWG #20-22(0.50~0.35mm<sup>2</sup>)
- Insulation O.D: 1.85mm Max
- Used In GYA Housing: 3025HM
- "★" Critical dimension

3025 T F-P XXX X-B

① ② ③ ④ ⑤ ⑥ ⑦

- ① Series Number
- ② Category: T-terminal
- ③ Connector type: F-Female Terminal
- ④ Material: P-Phosphor bronze
- ⑤ Plating Code:
  - G30- Ni 20u" Min ; Contact Area 30u" Au
  - G15- Ni 20u" Min ; Contact Area 15u" Au
  - G01- Ni 50u" Min ; Contact Area Gold Flash
  - SN- Ni: 50u" Min Bright Tin 100u" Min
- ⑥ Plating method: Blank-Stamping before plating
- ⑦ Mold No./Mark/Special No. B-B Type

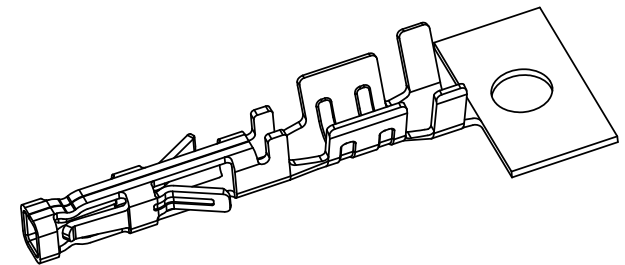
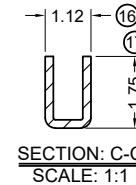
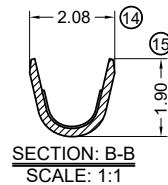
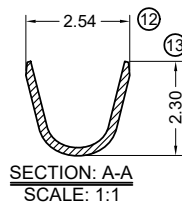
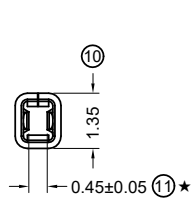

					GENERAL TOLERANCE .X ±0.30 .XX ±0.20 .XXX ±0.10 X.° ±2°				东莞市国亚电子有限公司 DONGGUO GUOYA ELECTRONICS CO.,LTD				PART NO. 3025TF-PXXX-B												
					APPROVAL YANG				CHECK TIAN				DRAWN TIAN				DATE 2016/07/19				TITLE 3.00mm Crimp Style Connectors				
DATE	REV	ECN NO.	DESCRIPTION	MODIFY	APPROVAL	PROJECT		UNIT		SCALE		SHEET		REV		NUMBER									
1		2		4				mm		1:1		1/1		A0		A-000									

RoHS

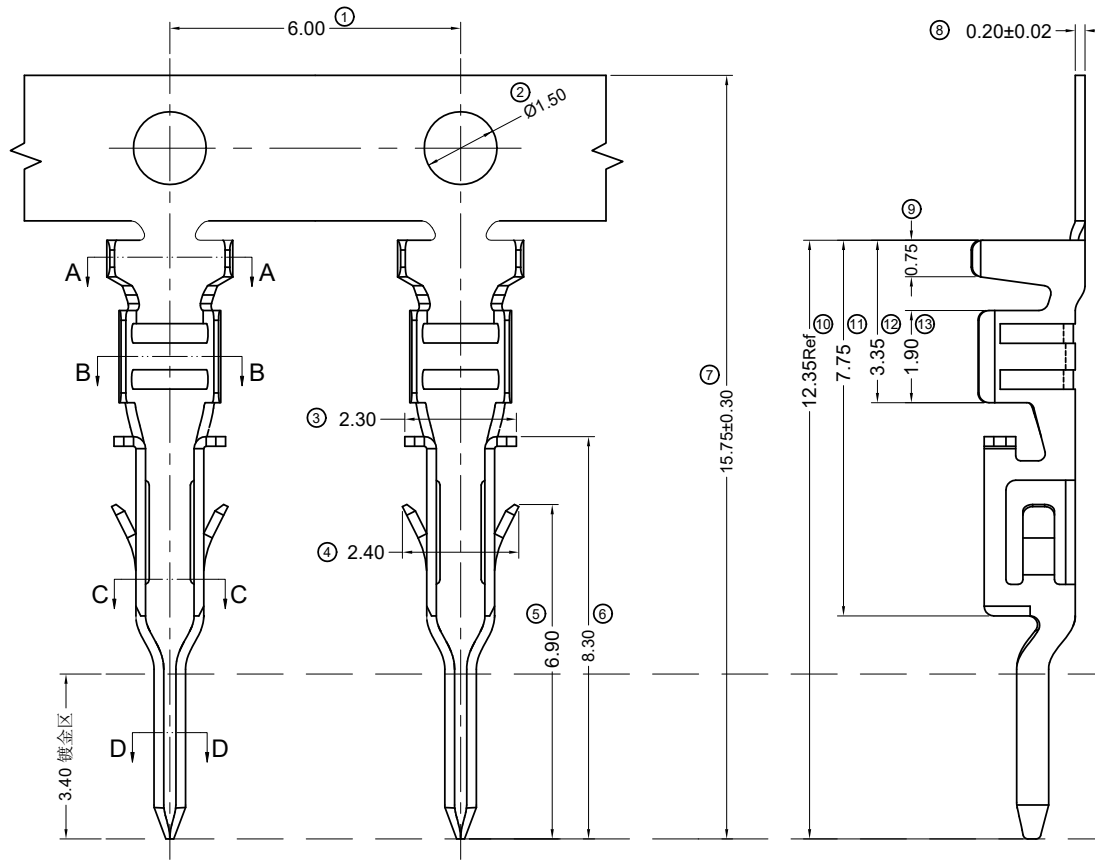

- Specifications :
- Voltage rating: 250V AC / DC
  - Current rating: 5A Max AC / DC
  - Withstanding voltage: 1000V AC/minute
  - Temperature range: -40°C~+105°C
  - Insulation resistance: ≥1000MΩ
  - Contact resistance: ≤10mΩ
  - After environmental testing: ≤20mΩ

- Wire Size: AWG#20~22(0.5~0.35mm<sup>2</sup>)
- Insulation O.D.: 1.85mm Max
- Used In GYA Housing: 3025HF
- "★"Critical dimension

3025 T M-P XX X-X

① ② ③ ④ ⑤ ⑥ ⑦

- ① Series Number
- ② Category: T-terminal
- ③ Shape: M-male
- ④ Material: P-Phosphor bronze
- ⑤ Plating code:  
SN-Bright tin plating(30u" Ni Min;70u"Sn Min)  
G30-Contact point gold 30u ",Other area Ni 30u" Min
- ⑥ Plating method: Blank-Stamping before plating
- ⑦ Mold No./Mark/Special No.

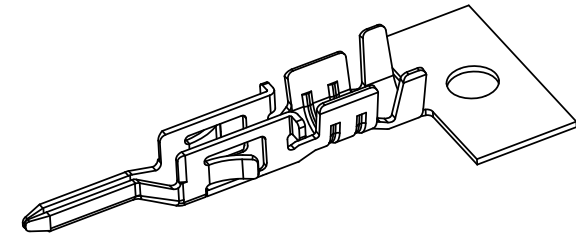
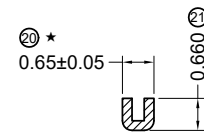
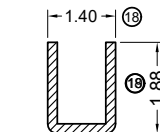
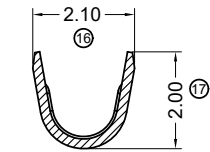
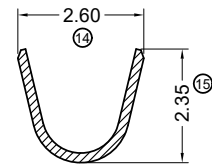

					GENERAL TOLERANCE .X ±0.30 .XX ±0.20 .XXX ±0.10 X.° ±2°				东莞市国亚电子有限公司 DONGGUO GUOYA ELECTRONICS CO.,LTD				PART NO. 3025TM-PSN							
					APPROVAL YANG				CHECK TIAN		DRAWN TIAN		DATE 2015/04/10			TITLE 3.00mm Crimp Style Connectors				
DATE	REV	ECN NO.	DESCRIPTION	MODIFY	APPROVAL	PROJECT		UNIT	SCALE	SHEET	REV	NUMBER								
								mm	1:1	1/1	A0	A-000								

RoHS

RD-1

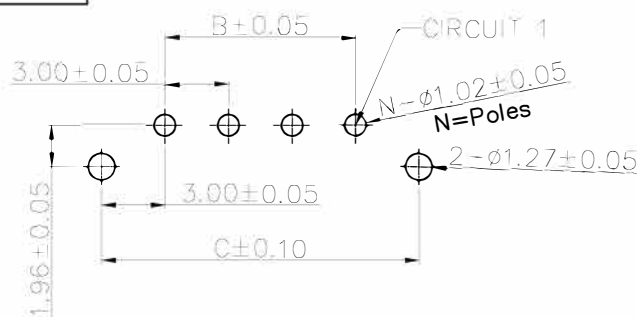
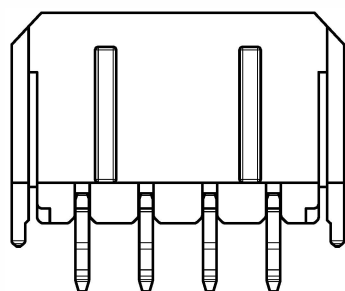
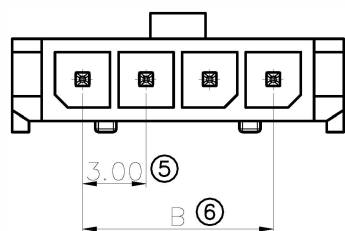
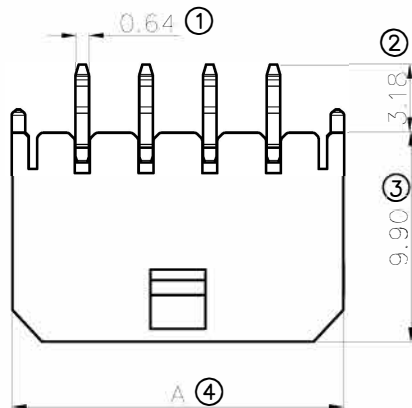

Recommended P.C.B Layout(T=1.6mm)

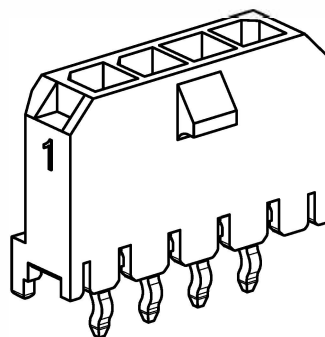
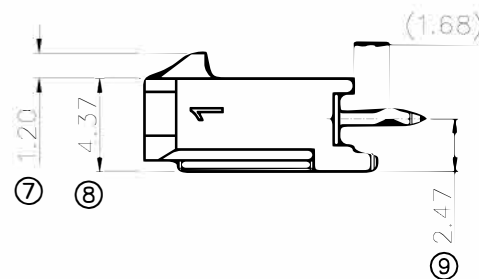

Specifications:

- Voltage rating: 250V Max AC/DC
- Current rating: 5A AC/DC
- Withstanding voltage: 1000V AC/minute
- Temperature range: -40°C~+105°C
- Insulation resistance: ≥1000MΩ
- Contact resistance: ≤10mΩ
- After environmental testing: ≤20mΩ
- Product Specification: PS-3025-11

3025 W V X-XX I- LP SW1 BK T  
 ① ② ③ ④ ⑤ ⑥ ⑦ ⑧ ⑨ ⑩

- ① Series No.
- ② Category: W-wafer
- ③ Connector Type: V- Straight 180°
- ④ Mounting Type: Blank-DIP
- ⑤ Row No.-Pin No.: XX-02Pin~12Pin
- ⑥ Special No.: I-Stamping terminal
- ⑦ Plastic material: LP-LCP UL94V-0
- ⑧ Planting Code: SW1-Matte tin  
 Ni: 40~120u"(1~3um);  
 Matte Tin: 80~200u"(2~5um).
- ⑨ Color: Bk-Black
- ⑩ Packing: T-Tray

Poles	Dimensions/mm		
	A	B	C
2	9.65	3.00	9.00
3	12.65	6.00	12.00
4	15.65	9.00	15.00
5	18.65	12.00	18.00
6	21.65	15.00	21.00
7	24.65	18.00	24.00
8	27.65	21.00	27.00
9	30.65	24.00	30.00
10	33.65	27.00	33.00
11	36.65	30.00	36.00
12	39.65	33.00	39.00

A

GENERAL TOLERANCE
.X ±0.30
.XX ±0.20
.XXX ±0.10
X.* ±2°



东莞市国亚电子有限公司  
 DONGGUO GUOYA ELECTRONICS CO.,LTD

PART NO.  
 3025WV-XXI-LPSW1BKT  
 TITLE Micro-fit(3.0) single row vertical DIP CONN.

APPROVAL	CHECK	DRAWN	DATE
YANG	TIAN	TIAN	2020/02/26

UNIT	SCALE	SHEET	REV	NUMBER
mm	3:1	1/1	A0	XXXX

DATE	REV	ECN NO.	DESCRIPTION	MODIFY	APPROVAL
------	-----	---------	-------------	--------	----------

1 2 3 4 5 6 7 8

RoHS

- Specifications :
- Voltage rating: 250V AC / DC
  - Current rating: 5A Max AC / DC
  - Withstanding voltage: 1000V AC/minute
  - Temperature range: -25°C~+85°C(PA66 94V-0)  
-40°C~+105°C(LCP 94V-0)
  - Insulation resistance: ≥1000MΩ
  - Contact resistance: ≤10mΩ
  - After environmental testing: ≤20mΩ

3025 W V X- XX XX -XX XX XX - 07

- ① ② ③ ④ ⑤ ⑥ ⑦ ⑧ ⑨
- ① Series No.
  - ② Category: W-Wafer
  - ③ Connector Type: V-180°
  - ④ Mouting Type: Blank-DIP
  - ⑤ Row No.-Pin No Per Row: XX-Single row
  - ⑥ Special NO.: Blank-ordinary
  - ⑦ Material : N0-PA66 94V-0; LP-LCP 94V-0
  - ⑧ Plating Code: SN-Bright Tin ; SW-Matte Tin
  - ⑨ Color: Blank-Black

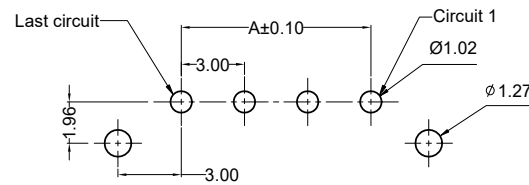
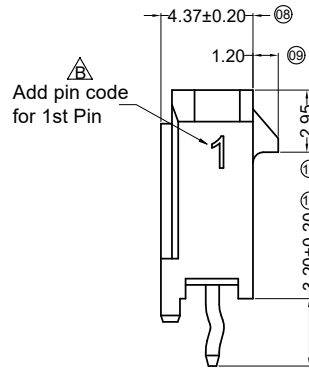
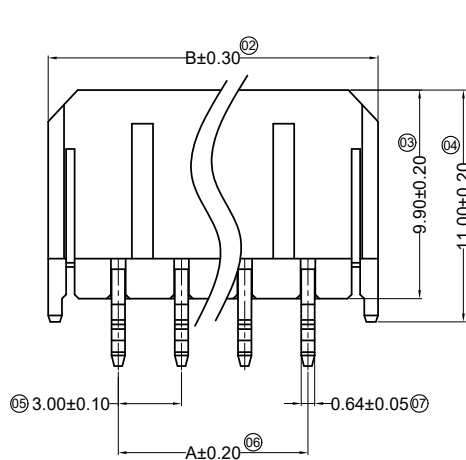
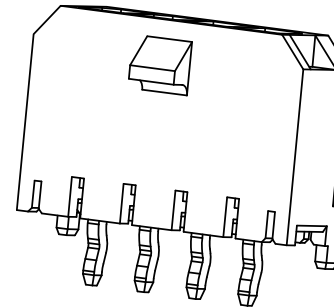
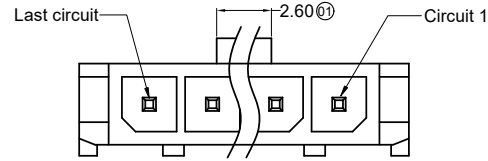

Recommended P.C.B Layout  
General Tolerance±0.05

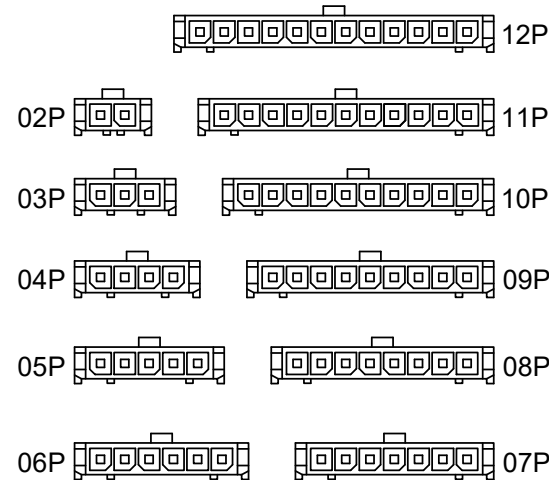

CIRCUIT SIZE LAYOUT

Poles	Dimensions (mm)	
	A	B
2	3.00	9.65
3	6.00	12.65
4	9.00	15.65
5	12.00	18.65
6	15.00	21.65
7	18.00	24.65
8	21.00	27.65
9	24.00	30.65
10	27.00	33.65
11	30.00	36.65
12	33.00	39.65

					GENERAL TOLERANCE		<b>东莞市国亚电子有限公司</b> DONGGUO GUOYA ELECTRONICS CO.,LTD				PART NO. 3025WV-XX-XXXX-07					
					.X ±0.30						TITLE 3.00 mm Crimp Style Connectors					
					.XX ±0.20		APPROVAL		CHECK	DRAWN						DATE
					.XXX ±0.10		YANG		TIAN	TIAN	2020/02/26	SCALE	SHEET	REV	NUMBER	
					X.° ±2°		PROJECT					mm	1:1	1/1	A0	A-007
DATE	REV	ECN NO.	DESCRIPTION	MODIFY	APPROVAL	PROJECT										

1 2 3 4 5 6 7 8





RoHS

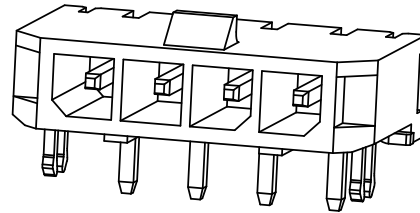
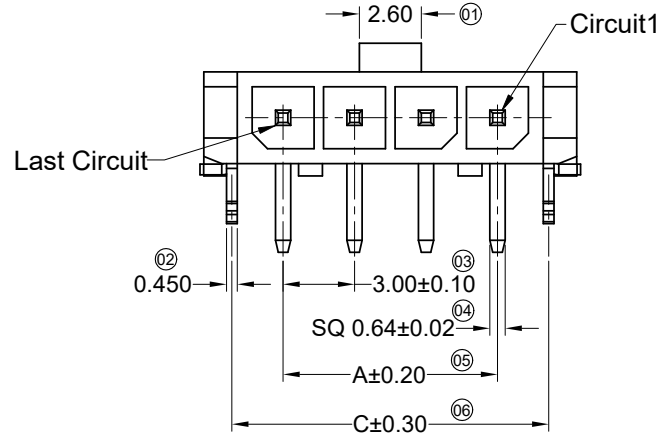

■ Specifications :

- Voltage rating: 250V AC / DC
- Current rating: 5A Max AC / DC
- Withstanding voltage: 1000V AC/minute
- Temperature range: -40°C~+105°C
- Insulation resistance: ≥1000MΩ
- Contact resistance: ≤10mΩ
- After environmental testing: ≤20mΩ
- Material(Pin): Brass
- Mates With GYA Housing: 3025HM-XX

3025 W R X - XX C1 - LP SN XX  
 ① ② ③ ④ ⑤ ⑥ ⑦ ⑧ ⑨

- ① Series No.
- ② Category: W-Wafer
- ③ Connector Type: R-90°
- ④ Mounting Type: Blank-DIP
- ⑤ Row No.-Pin No.: XX-01P~12P
- ⑥ Special No.: C1-The harpoon 2.00mm
- ⑦ Material: LP-LCP 94V-0
- ⑧ Plating Code: SN-Bright Tin
- ⑨ Color: Blank-Natural Color Black

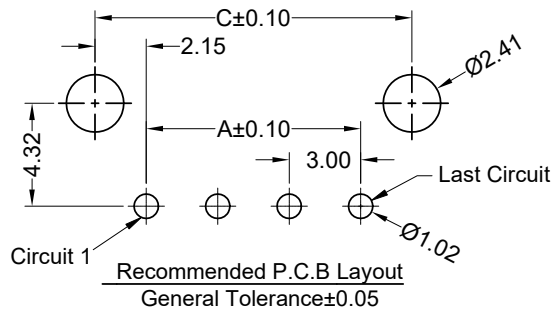
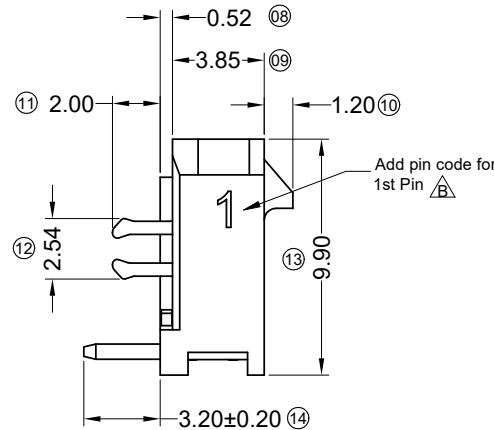
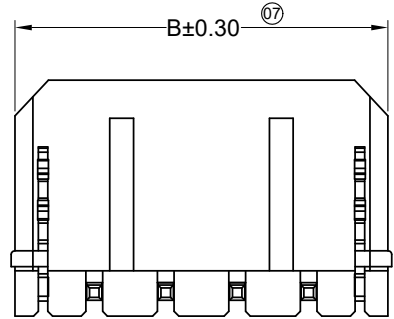

Poles	Dimensions(mm)			Poles	Dimensions(mm)		
	A	B	C		A	B	C
01	---	6.65	4.30	07	18.00	24.65	21.30
02	3.00	9.65	7.30	08	21.00	27.65	24.30
03	6.00	12.65	10.30	09	24.00	30.65	27.30
04	9.00	15.65	13.30	10	27.00	33.65	30.30
05	12.00	18.65	16.30	11	30.00	36.65	33.30
06	15.00	21.65	19.30	12	33.00	39.65	34.30

					GENERAL TOLERANCE .X ±0.30 .XX ±0.20 .XXX ±0.10 X.° ±2°				东莞市国亚电子有限公司 DONGGUO GUOYA ELECTRONICS CO.,LTD				PART NO. 3025WR-XXC1-LPSN								
					APPROVAL YANG				CHECK TIAN				DRAWN TIAN				DATE 2015/05/05				
					PROJECT 				TITLE 3.00mm Crimp Style Connectors												
DATE	REV	ECN NO.	DESCRIPTION	MODIFY	APPROVAL	UNIT		SCALE		SHEET		REV		NUMBER							
1		2		4		mm		1:1		1/1		A0		A-000							

RoHS

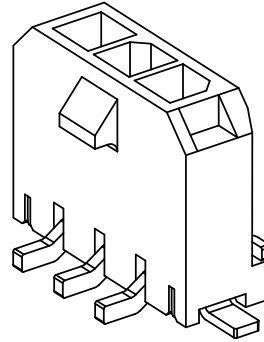
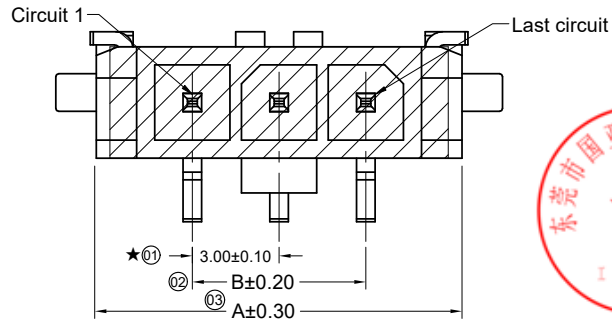

■ Specifications :

- Voltage rating: 250V AC / DC
- Current rating: 5A Max AC / DC
- Withstanding voltage: 1000V AC/minute
- Temperature range: -40°C~+105°C
- Insulation resistance: ≥1000MΩ
- Contact resistance: ≤10mΩ
- After environmental testing: ≤20mΩ
- Material(Pin&Solder Tabs): Brass
- Finish(Solder Tabs): Matte Tin Plating
- Mates With GYA Housing: 3025HM-XX
- "★"Critical dimension

3025 W V S- XX D-LP XX X W  
 ① ② ③ ④ ⑤ ⑥ ⑦ ⑧ ⑨ ⑩

- ① Series No.
- ② Category: W-Wafer
- ③ Connector Type: V-180°
- ④ Mounting Type: S-SMT
- ⑤ Row No.-Pin No Per Row: XX-Single Row
- ⑥ Special No.: D-Solder Tabs
- ⑦ Material: LP-LCP 94V-0
- ⑧ Plating Code:  
SW- Matte Tin  
G30-Contact Area Au 30u" Min;
- ⑨ Color: Blank-Black
- ⑩ Packing: W-Mylar+Reel

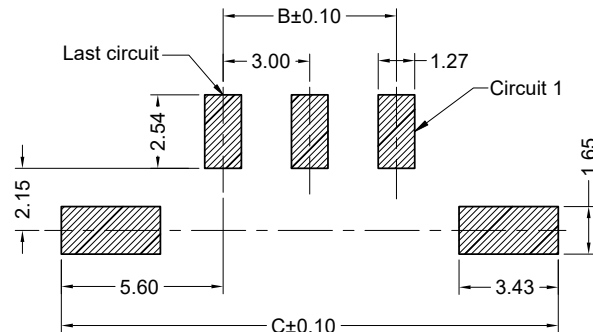
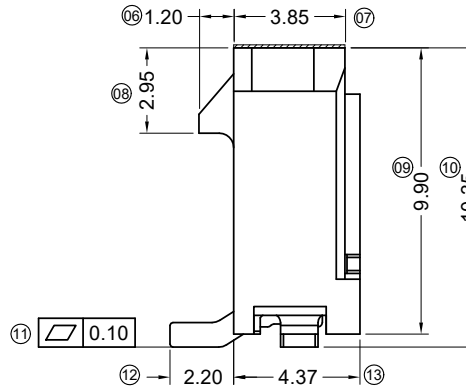
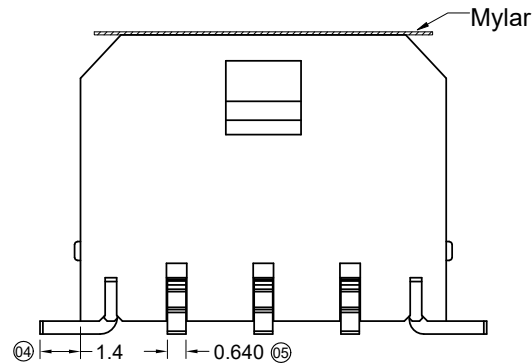

Recommended P.C.B Layout  
 General Tolerance±0.05

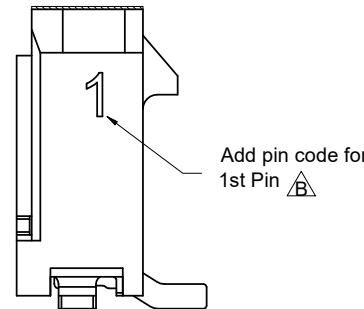

Poles	Dimensions(mm)		
	A	B	C
02	9.65	3.00	14.20
03	12.65	6.00	17.20
04	15.65	9.00	20.20
05	18.65	12.00	23.20
06	21.65	15.00	26.20
07	24.65	18.00	29.20
08	27.65	21.00	32.20
09	30.65	24.00	35.20
10	33.65	27.00	38.20
11	36.65	30.00	41.20
12	39.65	33.00	44.20

GENERAL TOLERANCE					GYA Connectors	APPROVAL				PART NO.					
.X ±0.30						东莞市国亚电子有限公司 DONGGUO GUOYA ELECTRONICS CO.,LTD	YANG	TIAN	TIAN	2019/02/20	3025WVS-XXD-LPXXXW				
.XX ±0.20					CHECK DATE				TITLE						
.XXX ±0.10					DRAWN				3.00mm Crimp Style Connectors						
X.° ±2°					DATE				UNIT SCALE SHEET REV NUMBER						
DATE	REV	ECN NO.	DESCRIPTION	MODIFY	APPROVAL	PROJECT					mm	1:1	1/1	A0	A-000

RoHS

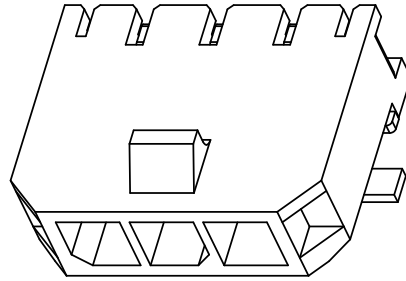
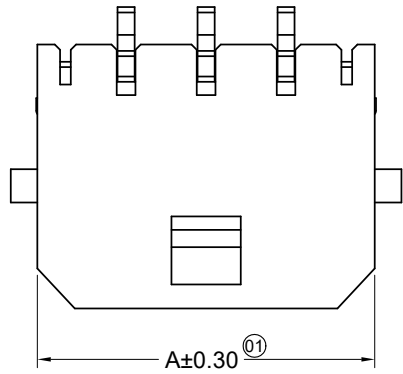

■ Specifications :

- Voltage rating: 250V AC / DC
- Current rating: 5A Max AC / DC
- Withstanding voltage: 1000V AC/minute
- Temperature range: -40°C~+105°C
- Insulation resistance: ≥1000MΩ
- Contact resistance: ≤10mΩ
- After environmental testing: ≤20mΩ
- Material(Pin): Brass
- Material(Solder Tabs): Brass
- Finish(Solder Tabs): Matte Tin
- Mates With GYA Housing: 3025HM-XX
- "★"Critical dimension

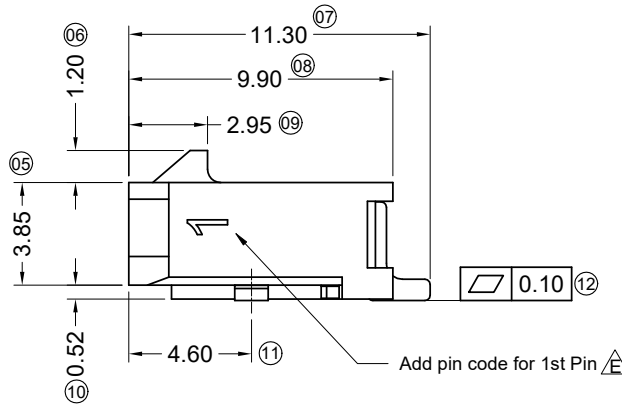
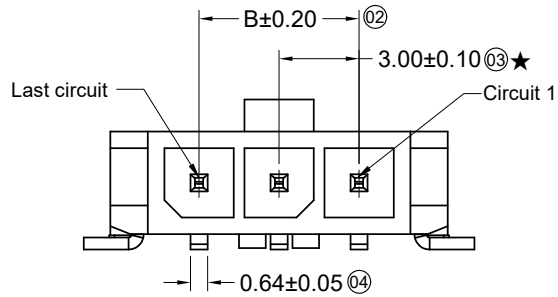

3025 W R S- XX D-LP SW XX

① ② ③ ④ ⑤ ⑥ ⑦ ⑧ ⑨

- ① Series No.
- ② Category: W-Wafer
- ③ Connector Type: R-Right Angle 90°
- ④ Mounting Type: S-SMT
- ⑤ Row No.-Pin No Per Row: XX-Single Row
- ⑥ Special NO. : D-Solder Tabs
- ⑦ Material: LP-LCP 94V-0
- ⑧ Plating Code:  
SW- Ni 50u" Min ; Matte Tin 100u"Min  
G15- Contact Area Au 15u" Min  
Solder Area Ni 50u" Min ; Matte Tin 100u"Min
- ⑨ Color: Blank-Black Color

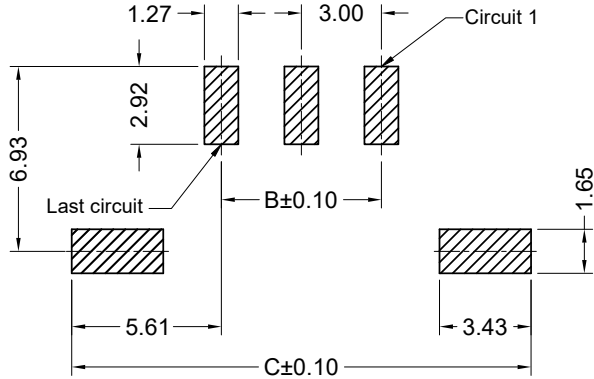

RECOMMENDED P.C.B LAYOUT  
(TOLERANCE:±0.05)



Poles	Dimensions(mm)		
	A	B	C
02	9.65	3.00	14.20
03	12.65	6.00	17.20
04	15.65	9.00	20.20
05	18.65	12.00	23.20
06	21.65	15.00	26.20
07	24.65	18.00	29.20
08	27.65	21.00	32.20
09	30.65	24.00	35.20
10	33.65	27.00	38.20
11	36.65	30.00	41.20
12	39.65	33.00	44.20

					GENERAL TOLERANCE .X ±0.30 .XX ±0.20 .XXX ±0.10 X.° ±2°		东莞市国亚电子有限公司 DONGGUO GUOYA ELECTRONICS CO.,LTD				PART NO. 3025WRS-XXD-LPXXX				
					PROJECT		APPROVAL	CHECK	DRAWN	DATE	TITLE 3.00 mm Crimp Style Connectors				
DATE	REV	ECN NO.	DESCRIPTION	MODIFY	APPROVAL	YANG	TIAN	TIAN	2007/05/03	UNIT	SCALE	SHEET	REV	NUMBER	
										mm	1 : 1	1/1	A0	A-000	