

- Specifications :
- Voltage rating: 200V AC / DC
 - Current rating: 1A AC / DC
 - Withstanding voltage: 500V AC/minute
 - Temperature range: $-40^{\circ} \sim +105^{\circ}$
 - Insulation resistance: $\geq 100M\Omega$
 - Contact resistance: $\leq 40m\Omega$
 - After environmental testing: $\leq 50m\Omega$
 - Suitable GYA Terminal: 1255T
 - Mates With GYA Wafer: 1255W



1255 H X - XX X - N0 XX
 ① ②③ ④⑤ ⑥ ⑦

- ① Series No.
- ② Category: H-HSG
- ③ Connector type: Blank-ordinary
- ④ Row No.-Pin No per row: XX-05P~41P
- ⑤ Special No.
- ⑥ Material: N0-PA66 94V-0
- ⑦ Color: Blank-Natural Color Black

Poles	Dimensions (mm)				Poles	Dimensions (mm)			
	A1	A2	B	C		A1	A2	B	C
05	2.50	1.25	6.00	4.90	17	10.00	8.75	13.50	12.40
07	3.75	2.50	7.25	6.15	19	11.25	10.00	14.75	13.65
09	5.00	3.75	8.50	7.40	21	12.50	11.25	16.00	14.90
11	6.25	5.00	9.75	8.65	31	18.75	17.50	22.25	21.15
13	7.50	6.25	11.00	9.90	41	25.00	23.75	28.50	27.40
15	8.75	7.50	12.25	11.15					

DATE	REV	ECN NO.	DESCRIPTION	MODIFY	APPROVAL
1					
2					
3					
4					

GYA 东莞市国亚电子有限公司
 Connectors Dong Guan Guo Ya Connectors co., Ltd.

APPROVAL: Yangzhengguo CHECK: Yangzhengyi DRAWN: Lviansheng DATE: 2016/08/26

PART NO.: 1255H-XX-N0

TITLE: 1.25mm Crimp Style Connectors

UNIT	SCALE	SHEET	REV	NUMBER
mm	1:1	1/1	A0	A-022

RoHS

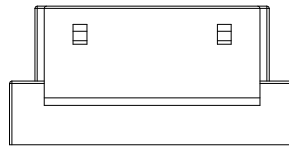
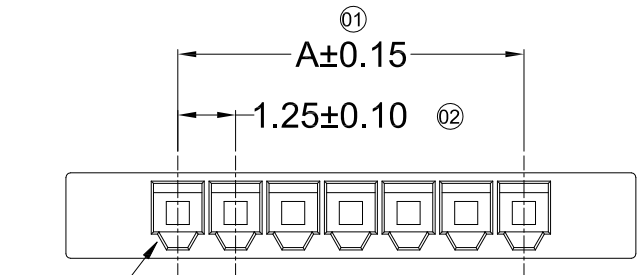

4P~30P Double Salient
Scale 1:5

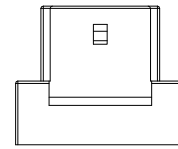

2P~3P Single Salient
Scale 1:5

■ Specifications :

- Voltage rating: 200V AC / DC
- Current rating: 1A AC / DC
- Withstanding voltage: 500V AC/minute
- Temperature range: -40° ~+105°
- Insulation resistance: ≥100MΩ
- Contact resistance: ≤40mΩ
- After environmental testing: ≤80mΩ
- Suitable GYA Terminal: 1255T
- Mates With GYA Wafer: 1255W

1255 H X - 1*XX X - N0 XX XX
 ① ②③ ④ ⑤ ⑥ ⑦ ⑧

- ① Series No.
- ② Category: H-HSG
- ③ Connector type: Blank-ordinary
- ④ Row No.-Pin No per row: 1*XX-1*02P~1*30P
- ⑤ Special No.:
- ⑥ Plastic material: N0-PA66 94V-0
- ⑦ Color: Blank-natural color
- ⑧ Blank-ROHS ; HF-Halogen free

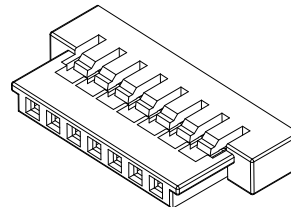
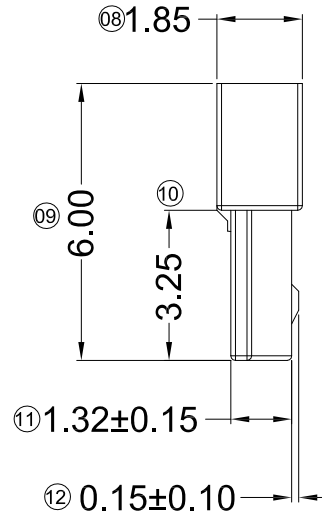
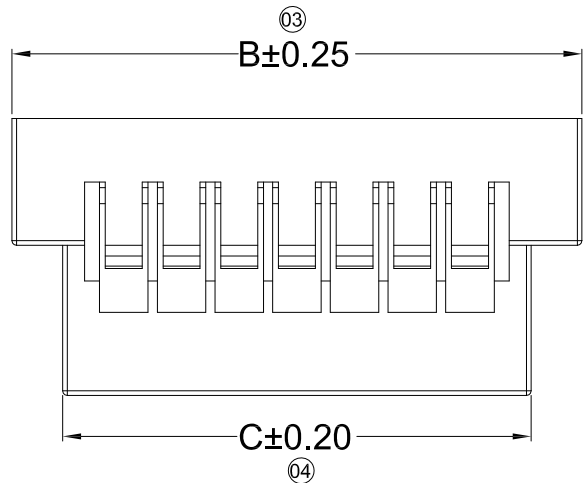

Poles	Dimensions(mm)			Poles	Dimensions(mm)		
	AB		C		AB		C
02	1.25	6.10	3.90	11	12.50	17.35	15.15
03	2.50	7.35	5.15	12	13.75	18.60	16.40
04	3.75	8.60	6.40	13	15.00	19.85	17.65
05	5.00	9.85	7.65	14	16.25	21.10	18.90
06	6.25	11.10	8.90	15	17.50	22.35	20.15
07	7.50	12.35	10.15	16	18.75	23.60	21.40
08	8.75	13.60	11.40	20	23.75	28.60	26.40
09	10.00	14.85	12.65	25	30.00	34.85	32.65
10	11.25	16.10	13.90	30	36.25	41.10	38.90

DATE	REV	ECN NO.	DESCRIPTION	MODIFY	APPROVAL
1					
2					
3					
4					
5					

GENERAL TOLERANCE	
.X	±0.30
.XX	±0.20
.XXX	±0.10
X.°	±2°
PROJECT	

GYA 东莞市国亚电子有限公司
 Connectors Dong Guan Guo Ya Connectors co., Ltd.

APPROVAL	CHECK	DRAWN	DATE
Yangzhengguo	Yangzhengyi	Lvtiansheng	2016/08/26

PART NO.: 1255H-1xXX-N0XX				
TITLE: 1.25mm Crimp Style Connectors				
UNIT	SCALE	SHEET	REV	NUMBER
mm	1:1	1/1	A0	A-022

RoHS

成品工程图

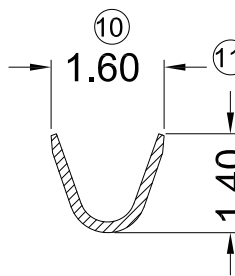
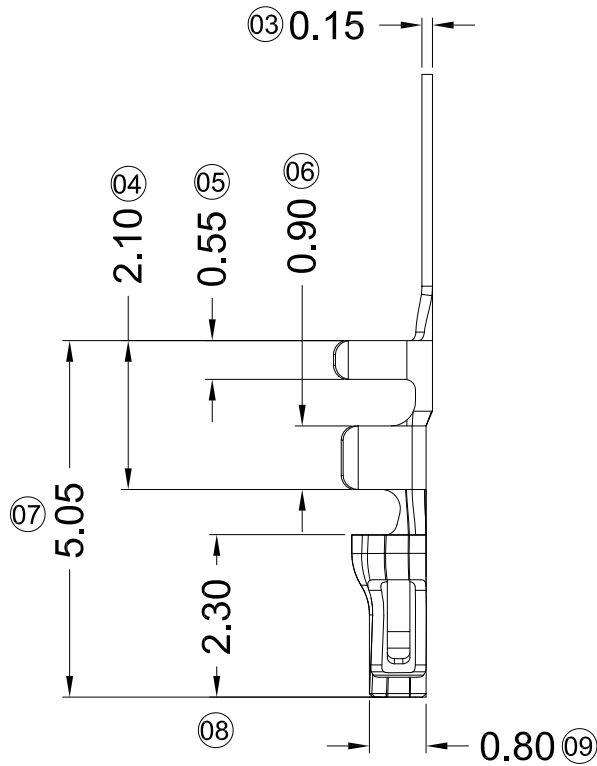
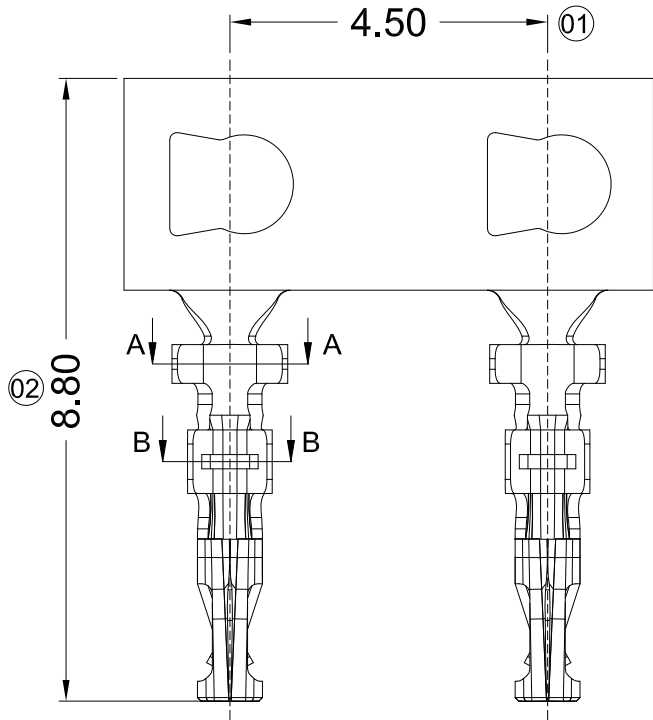

SECTION A-A
SCALE 1:1

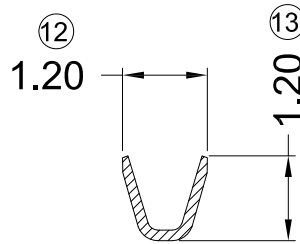

SECTION B-B
SCALE 1:1

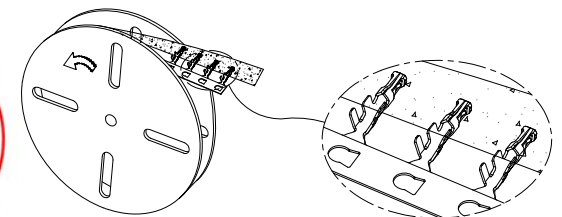
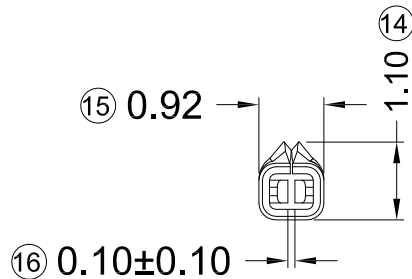

SCALE 4:1

- Specifications :
- Voltage rating: 200V AC / DC
 - Current rating: 1A AC / DC
 - Withstanding voltage: 500V AC/minute
 - Temperature range: -40° ~+105°
 - Insulation resistance: ≥100MΩ
 - Contact resistance: ≤40mΩ
 - After environmental testing: ≤80mΩ
 - Material(Pin): Phosphor bronze
 - Mates With GYA Housing : 1255H

1255 T X - P XX X - X
① ② ③ ④ ⑤ ⑥ ⑦

- ① Series Number
- ② Category: T-terminal
- ③ Shape: Blank-ordinary
- ④ Material: P-Phosphor bronze
- ⑤ Plating Code:
V01- Gold Flash
SN-Bright tin plating
- ⑥ Plating method:
Blank-Stamping before plating
- ⑦ Mold No./Mark/Special No.

DATE	REV	ECN NO.	DESCRIPTION	MODIFY	APPROVAL
1					
2					
3					
4					

GENERAL TOLERANCE
.X ±0.20
.XX ±0.15
.XXX ±0.08
X.° ±2°
PROJECT

GYA Connectors 东莞市国亚电子有限公司 Dong Guan Guo Ya Connectors co., Ltd.	APPROVAL	CHECK	DRAWN	DATE
	Yangzhengguo	Yangzhengyi	Lvtiansheng	2016/08/26

PART NO.: 1255T-PXX				
TITLE: 1.25mm Crimp Style Connectors				
UNIT	SCALE	SHEET	REV	NUMBER
mm	1:1	1/1	A0	A-014

RoHS



Specifications :

- Voltage rating: 200V AC / DC
- Current rating: 1A AC / DC
- Withstanding voltage: 500V AC/minute
- Temperature range: -40° ~+105°
- Insulation resistance: ≥100MΩ
- Contact resistance: ≤40mΩ
- After environmental testing: ≤80mΩ
- Material(Pin And Solder Tabs):Brass
- Mates With GYA Housing:1255H-1*XX

1255 W R S - 1*XX X - LP XX XX

① ② ③ ④ ⑤ ⑥ ⑦ ⑧ ⑨

- ① Series No.
- ② Category: W-wafer
- ③ Connector type: R- Right Angle 90°
- ④ Mounting type: S-SMT
- ⑤ Row No.-Pin No per row: 1*XX-02P~06P , 08P;
- ⑥ Special No.:
- ⑦ Material: LP-LCP 94V-0
- ⑧ Plating Code: V01-Gold Flash;
SW-Matte Tin plating
- ⑨ Color: Blank-natural color

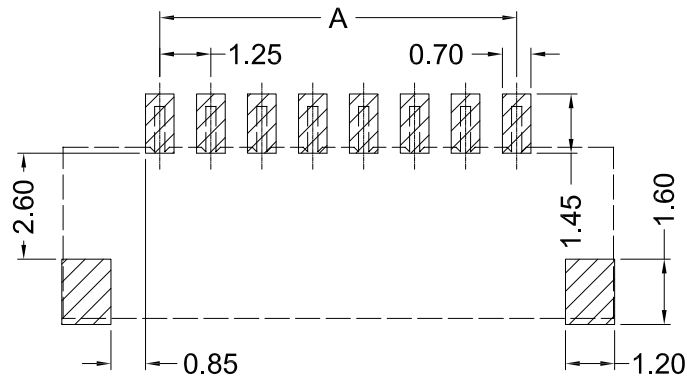
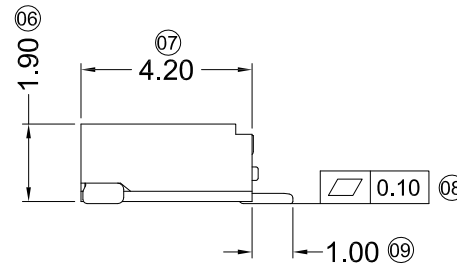
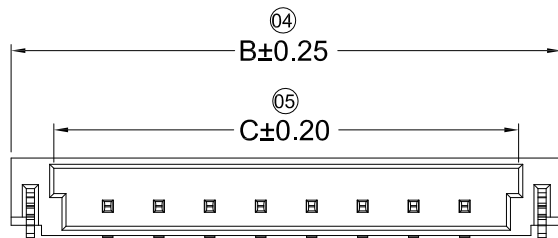
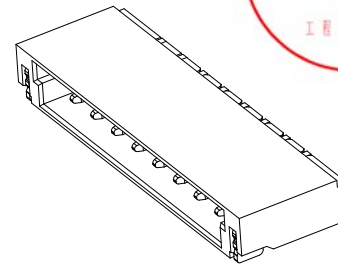
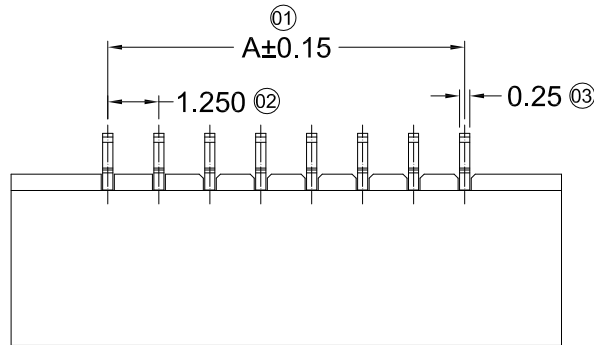

Recommended P.C.B Layout
General Tolerance±0.05

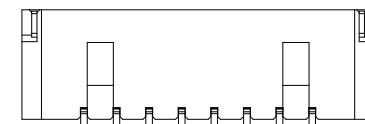

8P Double Hole
Scale 1:0.8

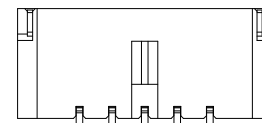

2P~6P Single Hole
Scale 1:0.8

Poles	Dimensions(mm)		
	A	B	C
02	1.25	6.00	3.90
03	2.50	7.25	5.15
04	3.75	8.50	6.40
05	5.00	9.75	7.65
06	6.25	11.00	8.90
08	8.75	13.50	11.40

GENERAL TOLERANCE

- .X ±0.30
- .XX ±0.20
- .XXX ±0.10
- X.° ±2°

PROJECT



东莞市国亚电子有限公司
Dong Guan Guo Ya Connectors co., Ltd.

APPROVAL

Yangzhengguo

CHECK

Yangzhengyi

DRAWN

Lvtiansheng

DATE

2016/08/26

PART NO.

1255WRS-1*XX-LPXX

TITLE

1.25mm Crimp Style Connectors

UNIT

mm

SCALE

1:1

SHEET

1/1

REV

A0

NUMBER

A-082

DATE	REV	ECN NO.	DESCRIPTION	MODIFY	APPROVAL
1					
2					
3					
4					
5					

RoHS

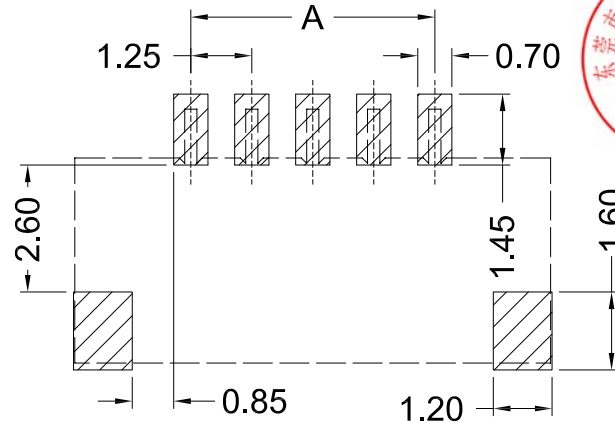
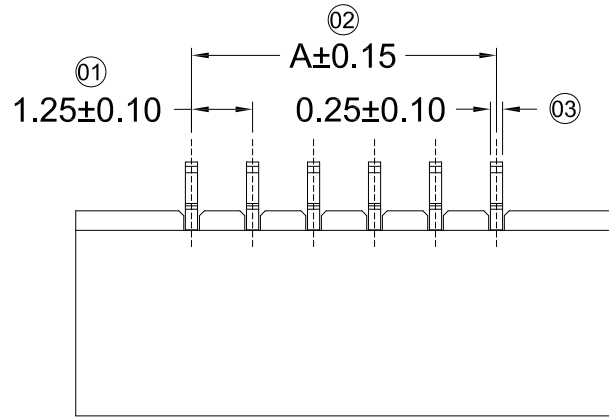
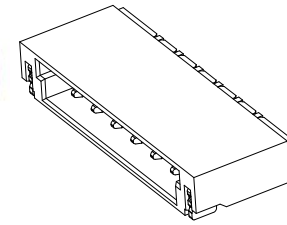

Recommended P.C.B Layout
General Tolerance±0.05

Specifications :

- Voltage rating: 200V AC / DC
- Current rating: 1A AC / DC
- Withstanding voltage: 500V AC/minute
- Temperature range: -40° ~+105°
- Insulation resistance: ≥100MΩ
- Contact resistance: ≤40mΩ
- After environmental testing: ≤80mΩ
- Material(Pin And Solder Tabs): Brass
- Mates With GYA Housing : 1255H

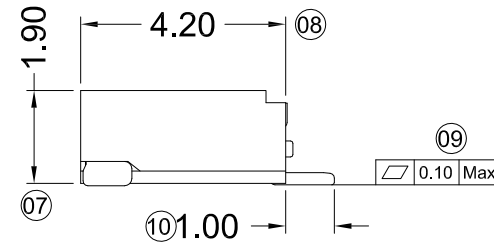
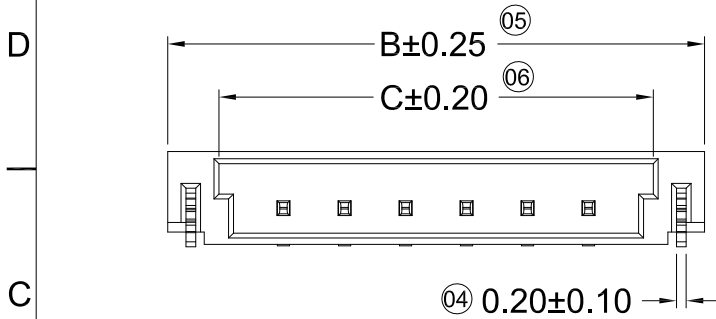

1255 W R S - 1*XX T - LP XX XX
① ② ③ ④ ⑤ ⑥ ⑦ ⑧ ⑨

- ① Series No.
- ② Category: W-wafer
- ③ Connector type: R- Right Angle 90°
- ④ Mouting type: S-SMT
- ⑤ Row No.-Pin No per row 1*XX-04P~06P
- ⑥ Special No.: T-Double Dole
- ⑦ Material: LP-LCP 94V-0
- ⑧ Plating Code: V01-Gold Flash;
SW-Matte Tin plating
- ⑨ Color: Blank-natural color

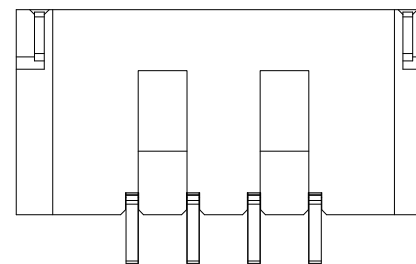
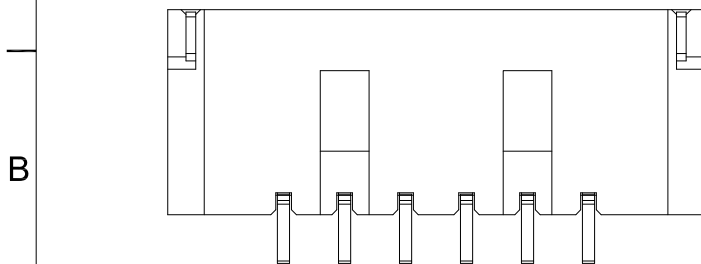

4P~6P Double

Poles	Dimensions(mm)		
	A	B	C
04	3.75	8.50	6.40
05	5.00	9.75	7.65
06	6.25	11.00	8.90

DATE	REV	ECN NO.	DESCRIPTION	MODIFY	APPROVAL
1					
2					
3					

GENERAL TOLERANCE	
.X	±0.30
.XX	±0.20
.XXX	±0.10
X.°	±2°
PROJECT	
⊕	⊖

	东莞市国亚电子有限公司 Dong Guan Guo Ya Connectors co., Ltd.			
	APPROVAL	CHECK	DRAWN	DATE
	Yangzhengguo	Yangzhengyi	Lvtiansheng	2016/08/26

PART NO.:				
1255WRS-1*XXT-LPXX				
TITLE: 1.25mm Crimp Style Connectors				
UNIT	SCALE	SHEET	REV	NUMBER
mm	1:1	1/1	A0	A-082